

# 5 PIECE FITTINGS FOR FCE-LFHB, IP 65, NICKEL PLATED BRASS

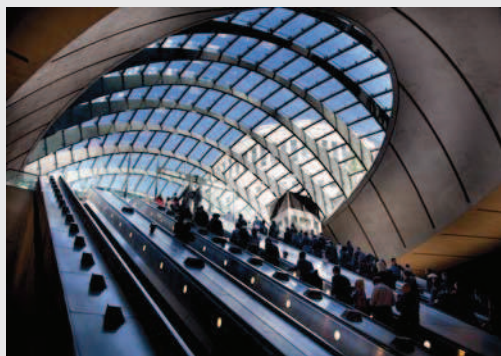

## Anaconda IP 65 nickel plated brass fittings for Multitite type FCE-LFHB

These fittings are made of **nickel plated brass** and specially for the Multitite type FCE-LFHB. These IP65 rated fittings are available in ISO (on request also Pg thread) and in various executions (straight, swivel, elbow and conduit connector) for use with Anaconda Multitite Type FCE-LFHB. This 5 piece fitting is designed to resist corrosion and handle tough operating conditions. The gripping construction on the outside of the braid provides an optimum tensile strength and improved shielding characteristics.



**Construction:** Nickel plated brass fitting, consisting of 5 parts (cap, intermediate body, clamping ring, ferrule and body)

**Material:** Cap, intermediate body and body are nickel plated brass. Ferrule is from passivated brass and clamping ring is from PA6.

**Temperature:** -45 °C till +105 °C continuous.

**Protection class:** IP 65.

**Colour:** Metal coloured.



### ISO straight fitting, compact, male, nickel plated brass (including connection set).



Thread	FCE-LFHB Size (DN)	Min. Internal Bore (mm)	Dimensions in mm					Standard Package	Article Number	Weight (Kg/100)
			A	B	C	D	E			
M16 x 1,5	16	11,2	48	10	24	-	24	10	732.016.4	9,5
M20 x 1,5	16	11,2	48	10	24	-	24	10	732.017.4	9,8
M20 x 1,5	20	15,2	51	10	28	-	27	10	732.020.4	11,5
M25 x 1,5	25	19,2	52	10	34	-	33	5	732.025.4	16,0
M32 x 1,5	32	25,9	59	12	41	-	42	5	732.032.4	25,5

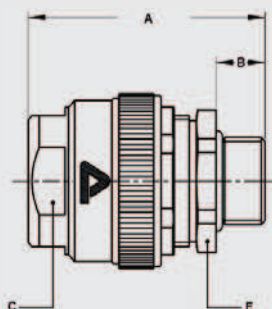

### ISO straight swivel fitting, male, nickel plated brass (including connection set).



Thread	FCE-LFHB Size (DN)	Min. Internal Bore (mm)	Dimensions in mm					Standard Package	Article Number	Weight (Kg/100)
			A	B	C	E	F			
M16 x 1,5	16	10,7	65	10	24	24	21	10	733.016.4	13,5
M20 x 1,5	20	13,9	68	10	28	27	25	10	733.020.4	16,0
M25 x 1,5	25	17,4	69	10	34	33	31	5	733.025.4	23,0
M32 x 1,5	32	23,4	78	12	41	42	38	5	733.032.4	35,5

