

# Shrink Disc Type SDG

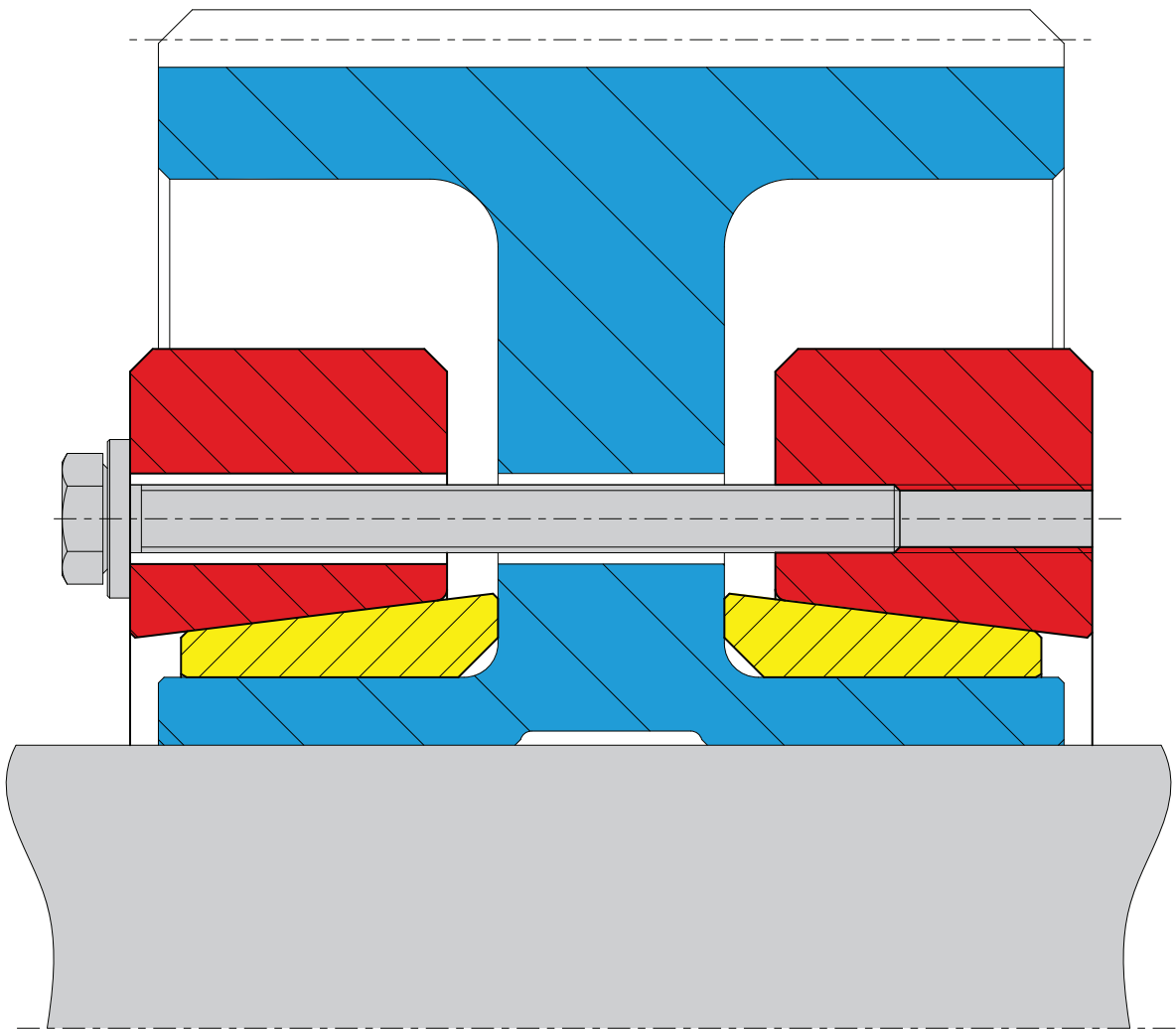

# Shrink Disc SDG

Series 91

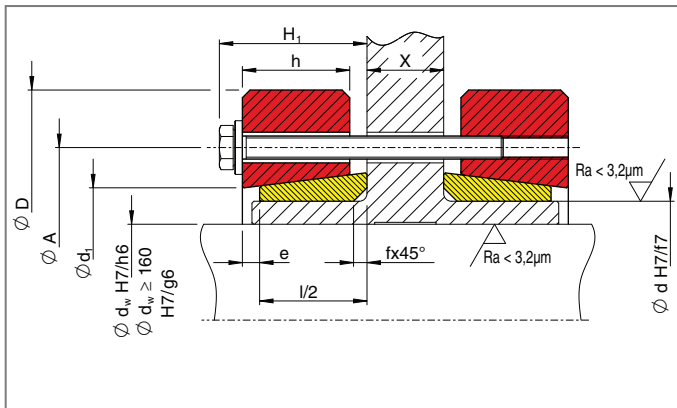

## Code:

- $M_t$  maximum transmissible torque of a shrink disc with  $P_{ax}=0$
- $P_{ax}$  maximum transmissible axial load of a shrink disc with  $M_t=0$
- $M_a$  required tightening torque of the tightening bolts (see also "Mounting and Removal Instructions")

Dimensions  $H_1$  and  $e$  apply to untightened units.

Type	d mm	d <sub>w</sub> mm	M <sub>t</sub> kNm	P <sub>ax</sub> kN	M <sub>a</sub> Nm	Tightening bolts*	D mm	l/2 mm	h mm	H <sub>1</sub> mm	A mm	d <sub>1</sub> mm	e mm	f mm	kg
SDG 140 - 91	140	95	23	476	100	12 x M12	230	35	32	50	175	145	7	5	14
		100	26	514											
		110	32	591											
SDG 155 - 91	155	110	34	618	100	15 x M12	263	38	35	53	198	165	7	5	20
		160	38	659											
		120	42	699											
SDG 165 - 91	165	120	49	818	240	10 x M16	290	41	38	63	210	176	8	5	27
		170	54	866											
		130	59	915											
SDG 175 - 91	175	130	55	852	240	10 x M16	300	41	38	63	220	186	8	5	28
		180	61	898											
		140	66	944											
SDG 185 - 91	185	140	93	1329	240	15 x M16	320	50	50	74	236	189	10	5	41
		190	101	1392											
		150	109	1456											
SDG 200 - 91	200	150	105	1393	240	15 x M16	340	51	50	75	246	204	10	5	45
		195	113	1455											
		160	121	1517											
SDG 220 - 91	220	160	140	1744	240	20 x M16	370	65	57	88	270	224	10	8	67
		165	150	1820											
		170	161	1895											
SDG 240 - 91	240	170	172	2025	470	15 x M20	405	68	65	97	295	244	12	8	84
		180	197	2184											
		190	223	2345											
SDG 260 - 91	260	190	205	2162	470	16 x M20	430	76	72	104	321	265	12	8	104
		200	232	2323											
		210	261	2486											
SDG 280 - 91	280	210	301	2870	470	20 x M20	460	84	78	113	340	285	12	10	131
		220	336	3054											
		230	373	3239											
SDG 300 - 91	300	220	307	2790	470	20 x M20	485	86	80	115	364	305	12	10	146
		230	341	2962											
		240	376	3137											
SDG 320 - 91	320	240	422	3518	470	24 x M20	520	90	82	116	386	325	12	10	176
		250	464	3710											
		260	507	3903											
SDG 340 - 91	340	250	515	4118	820	20 x M24	570	98	92	129	420	345	12	10	239
		260	564	4335											
		270	615	4554											
SDG 360 - 91	360	270	571	4232	820	20 x M24	590	100	92	131	432	365	12	10	255
		350	622	4440											
		290	674	4648											
SDG 390 - 91	390	300	793	5289	820	24 x M24	660	109	96	139	468	397	12	15	361
		380	855	5514											
		320	919	5741											

Further sizes on request. Technical changes to be reserved without notice.

\*Tightening bolts: standard DIN EN ISO 4014/4017 Güte 10.9, alternative DIN EN ISO 4762 Grade 10.9

M 16 and upwards with washers: DIN EN ISO 7416 When ordering please state : SDG200-91 x 200 (Type x Ø d) Dimension X