

SCL2/SCD2 Series

Internal structure/external dimensions

Internal structure and parts list

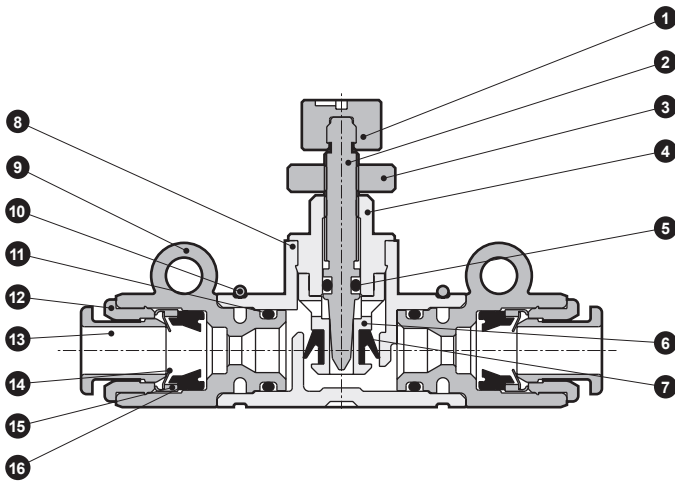

| No. | Parts name | Material |
|-----|--------------------|-----------------------------|
| 1 | Knob | PBT |
| 2 | Needle | Brass |
| 3 | Lock nut | Brass |
| 4 | Guide ring | Brass |
| 5 | O-ring | Nitrile rubber |
| 6 | Check bracket | Brass |
| 7 | Check packing seal | Hydrogenated nitrile rubber |
| 8 | Body | PBT |
| 9 | Joint case | PBT |
| 10 | Stopper ring | Stainless steel |
| 11 | O-ring | Nitrile rubber |
| 12 | Outer ring | Brass |
| 13 | Push ring | PBT |
| 14 | Chuck | Stainless steel |
| 15 | Holder | Brass or polyetherimide |
| 16 | Packing | Nitrile rubber |

*1 All the brass parts are plated with electroless nickeling.
 *2 All resin parts are flame resistance. (equivalent to UL94 standards V-0)
 Excluding applicable tube O. D. ϕ 1.8.

Dimensions



● SCL2 Series

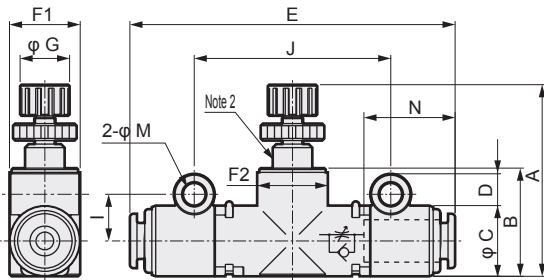

● SCD2 Series

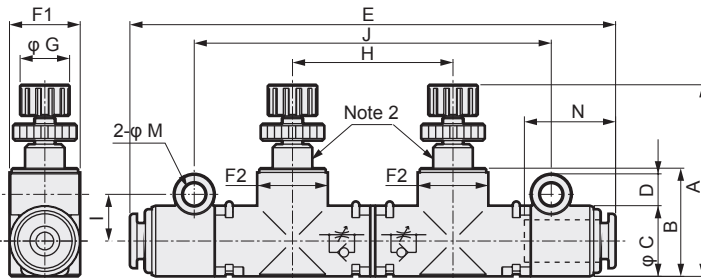

● Installation spacing dimensions for manifolds

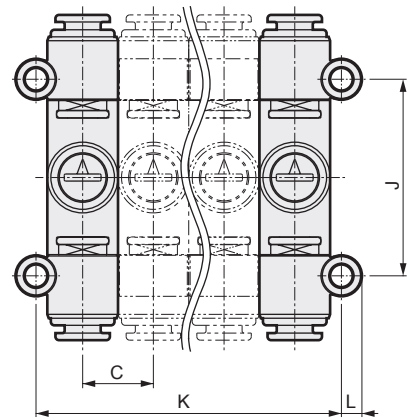

● Full view of fitting for the applicable tube O. D. ϕ 1.8

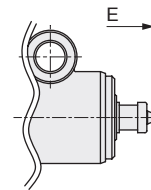

| Model no. | Piping size O.D. | A | | B | C | D | E | F1 | F2 | G | H | I | J | K | L | M (Installation hole) | N (tube insert length) |
|--------------------|----------------------|------|------|------|------|-----|------|----|------|----|------|------|------|---------------------|-----|--------------------------|---------------------------|
| | | MIN | MAX | | | | | | | | | | | | | | |
| SCL2-04-H22 note 1 | ϕ 1.8 | | | | | | 50.8 | | | | | | | | | | - |
| SCL2-04-H42 note 1 | ϕ 4/ ϕ 1.8 | 27.1 | 31.6 | 15.3 | 10 | 4.5 | 48.4 | 10 | 10.6 | 7 | - | 6.6 | 27.8 | $10 \times n + 3.2$ | 2.9 | 3.3 | 12.9/- |
| SCL2-04-H24 note 1 | ϕ 1.8/ ϕ 4 | | | | | | 48.4 | | | | | | | | | | -/12.9 |
| SCL2-04-H44 | ϕ 4 | | | | | | 46 | | | | | | | | | | 12.9 |
| SCL2-06-H66 | ϕ 6 | 28.8 | 33.3 | 17.7 | 12 | 5.6 | 49.4 | 12 | 12.2 | 7 | - | 8.1 | 30.8 | $12 \times n + 4.2$ | 3.5 | 4.3 | 13.7 |
| SCL2-08-H66 | ϕ 6 | 38 | 44.5 | 22.9 | 15 | 5.6 | 64 | 15 | 15.5 | 11 | - | 9.5 | 41 | $15 \times n + 4$ | 3.6 | | 18 |
| SCL2-08-H88 | ϕ 8 | | | | | | 66.5 | | | | | | | | | | 19 |
| SCL2-10-H88 | ϕ 8 | | | | | | 71 | | | | | | | | | | 19 |
| SCL2-10-H1010 | ϕ 10 | 44 | 50.5 | 29.7 | 20 | 5.1 | 75 | 20 | 20.5 | 11 | - | 11.5 | 47 | $20 \times n + 3$ | 3.6 | 4.3 | 21 |
| SCL2-10-H1212 | ϕ 12 | | | | | | 79 | | | | | | | | | | 22 |
| | | | | | 20.4 | 4.9 | | | | | | | | $20.4 \times n + 3$ | | | |
| SCD2-04-H22 note 1 | ϕ 1.8 | | | | | | 73.5 | | | | | | | | | | - |
| SCD2-04-H42 note 1 | ϕ 4/ ϕ 1.8 | 27.1 | 31.6 | 15.3 | 10 | 4.5 | 71.1 | 10 | 10.6 | 7 | 22.7 | 6.6 | 50.5 | $10 \times n + 3.2$ | 2.9 | 3.3 | 12.9/- |
| SCD2-04-H44 | ϕ 4 | | | | | | 68.7 | | | | | | | | | | 12.9 |
| SCD2-06-H66 | ϕ 6 | 28.8 | 33.3 | 17.7 | 12 | 5.6 | 73.9 | 12 | 12.2 | 7 | 24.5 | 8.1 | 55.3 | $12 \times n + 4.2$ | 3.5 | 4.3 | 13.7 |
| SCD2-08-H66 | ϕ 6 | 38 | 44.5 | 22.9 | 15 | 5.6 | 97.5 | 15 | 15.5 | 11 | 34 | 9.5 | 75 | $15 \times n + 4$ | 3.6 | | 18 |
| SCD2-08-H88 | ϕ 8 | | | | | | 100 | | | | | | | | | | 19 |
| SCD2-10-H88 | ϕ 8 | | | | | | 111 | | | | | | | | | | 19 |
| SCD2-10-H1010 | ϕ 10 | 44 | 50.5 | 29.7 | 20 | 5.1 | 115 | 20 | 20.5 | 11 | 40.5 | 11.5 | 87.5 | $20 \times n + 3$ | 3.6 | 4.3 | 21 |
| SCD2-10-H1212 | ϕ 12 | | | | | | 119 | | | | | | | | | | 22 |
| | | | | | 20.4 | 4.9 | | | | | | | | $20.4 \times n + 3$ | | | |

Note 1: Connection tubing is a fitting dedicated to fiber tube.

Note 2: There is a slit at this location on the fine speed type.

Note 3: F1 and F2 dimensions are oval.