

Korpus formy

Mold base

396x796

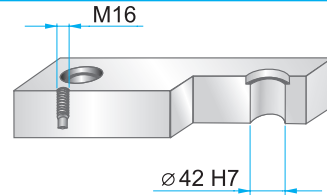
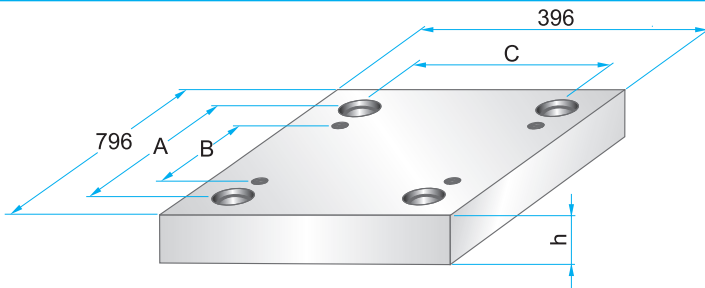

Wymiary i tolerancje
Dimensions and tolerances



	A	B	C
PK	724	630	324
PKA	724	630	324

PKA 01

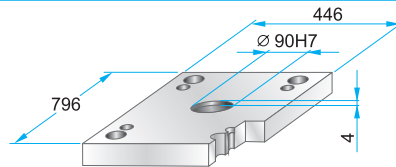
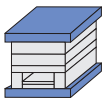

PKA 01 – 396 x 796 x h / material

h	material
46	1730
56	2312
	2085

**PK 11
PKA 11**

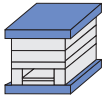

	W
PK 11	496
PKA 11	446

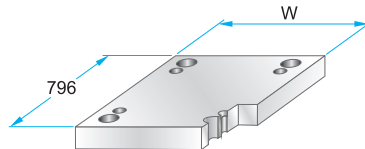

**PK 11 – 396 x 796 x h / material
PKA 11 – 396 x 796 x h / material**

h	material
46	1730
56	2312
	2085

**PK 02
PKA 02**

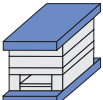

**PK 12
PKA 12**

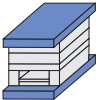

PKA 21

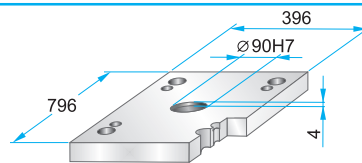

PKA 21 – 396 x 796 x h / material

h	material
46	1730
	2312
	2085

**PK 22
PKA 22**

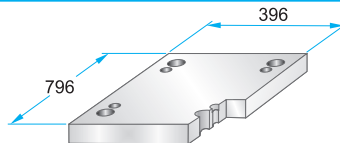
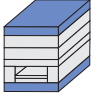

**PK 22 – 396 x 796 x h / material
PKA 22 – 396 x 796 x h / material**

h	material
36	1730
46	2312
	2085

**PK 03
PKA 03**

Podcięcia do demontażu
na życzenie.
Corner undercuts upon request.

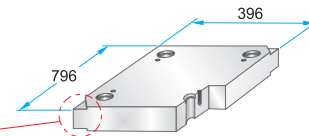

**PK 03 – 396 x 796 x h / material
PKA 03 – 396 x 796 x h / material**

**PK 35 – 396 x 796 x h / material
PKA 35 – 396 x 796 x h / (a1/b1/h1)**

22	1730
27	2083
36	2085
46	2162
56	2311
66	2312
76	2738
86	Toolox33
96	Toolox44
116	2738HH
136	2714HH
156	
176	

**PK 35
PKA 35**

Podcięcia do demontażu
na życzenie.
Corner undercuts upon request.

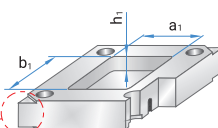

Material info



Korpus formy

Mold base

396x796

PK 31

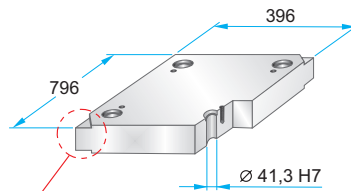
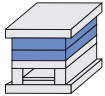

Podcięcia do demontażu na życzenie.
Corner undercuts upon request.



Material info



PK 31 - 396 x 796 x h / material

h	material
36	1730
46	2083
56	2085
66	2162
76	2311
86	2312
96	2343
116	2738
136	2767
156	Toolox33
176	Toolox44
	2738HH
	2714HH

**PK 04
PKA 04**

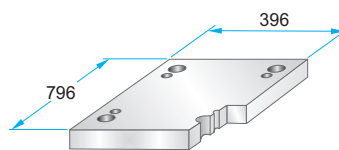
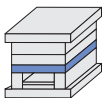

**PK 04 - 396 x 796 x h / material
PKA 04 - 396 x 796 x h / material**

h	material
46	1730
56	2312
	2085

**PK 05
PKA 05**

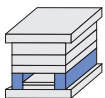

	A	B	M
PK 05	62	272	-
PKA 05	62	272	M10

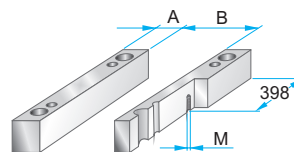

**PK 05 - 396 x 796 x h / material
PKA 05 - 396 x 796 x h / material**

h	material
76	1730
86	2085
96	
116	
136	
156	

**PK 55
PKA 55**

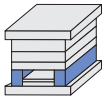

	A	B	M
PK 55	86	224	-
PKA 55	86	224	M10

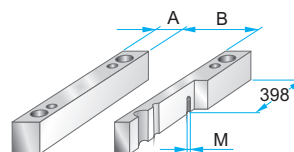

**PK 55 - 396 x 796 x h / material
PKA 55 - 396 x 796 x h / material**

h	material
76	1730
86	2085
96	
116	
136	
156	

**PK 06
PKA 06**

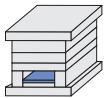

	A	B	C
PK 06	714	236	268
PKA 06	660	230	268

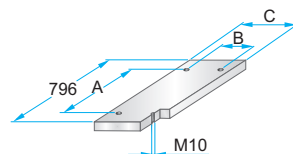

**PK 06 - 396 x 796 x h / material
PKA 06 - 396 x 796 x h / material**

h	material
27	1730
	2085

**PK 65
PKA 65**

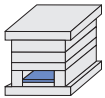

	A	B	C
PK 65	714	188	220
PKA 65	660	180	218

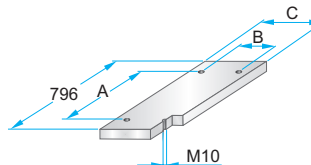

**PK 65 - 396 x 796 x h / material
PKA 65 - 396 x 796 x h / material**

h	material
27	1730
	2085

**PK 07
PKA 07**

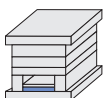

	A	B	C	D	M
PK 07	714	236	268	-	-
PKA 07	660	230	268	758	M5

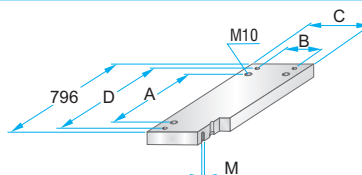

**PK 07 - 396 x 796 x h / material
PKA 07 - 396 x 796 x h / material**

h	material
36	1730
	2312
	2085

**PK 75
PKA 75**

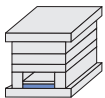

	A	B	C	D	M
PK 75	714	188	220	-	-
PKA 75	660	180	218	758	M5

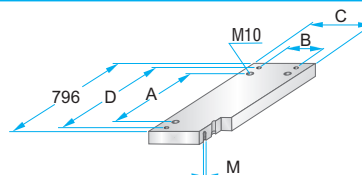

**PK 75 - 396 x 796 x h / material
PKA 75 - 396 x 796 x h / material**

h	material
36	1730
	2312
	2085