

DEMOUNTABLE GUIDE PILLAR WITH CENTRE FIXING AND RING NUT

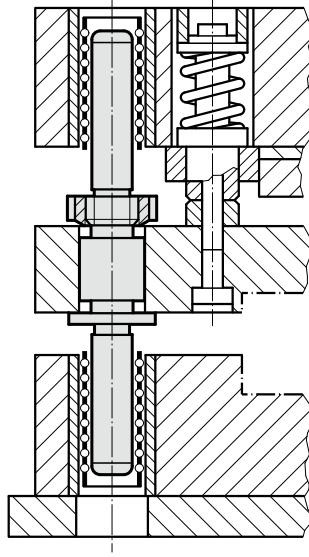

Mounting example



202.60.

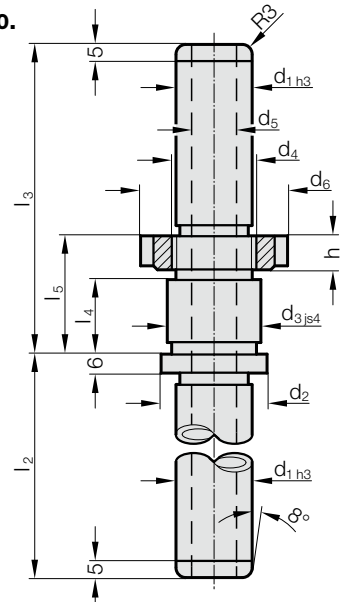

Material:

Steel, (Core strength: $\geq 900 \text{ N/mm}^2$) surface hardened
 Surface hardness: $60 + 3 \text{ HRC}$, Hardness penetration $\geq 1,8 \text{ mm}$

Execution:

precision ground

Note:

- ☞ Bearing clearance / Preloading see pairing classification at the beginning of chapter D.
- ☞ Matching guide combinations, see selection matrix at the beginning of chapter D.

☞ Bending equation see at the beginning of chapter D.

☞ Assembly guide lines / Dimensional requirements and tolerances at the end of chapter D.

Tolerance range:

- yellow = .10
- green = .20
- red = .30

202.60. Demountable guide pillar with centre fixing and ring nut

d_1	19	25	32	40
d_2	32	38	46	56
d_3	25	30	36	46
d_4	M22x1,5	M28x1,5	M35x1,5	M45x1,5
d_5	8	12	20	28
d_6	40	50	55	68
h	9	10	11	12
l_2	80	80	100	100
l_3	120	120	140	140
l_4	29	29	34	34
l_5	45	45	50	50

Ordering Code (example):

Demountable guide pillar with centre fixing and ring nut	=	202.60.
Diameter of conduit d_1	32 mm =	032.
Length with bush l_2	100 mm =	100.
Length to bush l_3	140 mm =	140.
Classification TOL	yellow =	10
Order No	=	202.60. 032. 100. 140. 10