

# LIFTING FLANGE WITH BOLT WITH SAFETY RING, TO AUDI

2133.11.10.

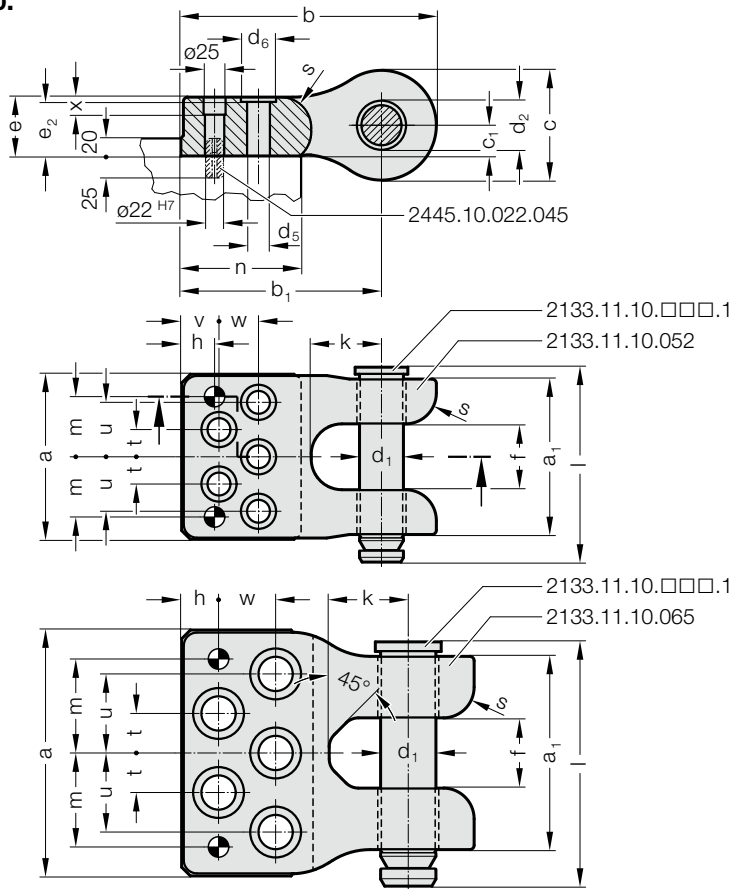

**Note:**

Centering pin 2445.10.022.045 to be ordered separately

Order No for spare part bolt with safety ring: 2133.11.10.□□□.1  
 Order No for lifting flange with bolt, with safety ring, two centering pins and fixing screws, to Audi: 2133.11.00.10.□□□

**2133.11.10. Lifting flange with bolt with safety ring, to Audi**

Order No	max. carrying capacity (2 lifting flanges) [kg]*																		Socket head cap screw							
		d <sub>1</sub>	d <sub>2</sub>	a	a <sub>1</sub>	b	b <sub>1</sub>	c	c <sub>1</sub>	e	f	h	k	l	m	n	s	t	u	v	w	x	d <sub>5</sub>	d <sub>6</sub>	e <sub>2</sub>	DIN EN ISO 4762
2133.11.00.10.052	16000	50	52	188	177	290	227.5	125	35	67	75	37.5	80	221	68.5	135	35	31	62	42.5	45	20	26	40	65	M24x100
2133.11.00.10.065	25000	63	65	280	220	333	258	150	47	91	80	42	90	277	107	150	35	45	90	42	65	46	39	58	84	M36x120

\*The maximum permissible load capacity is to be calculated such that two lifting flanges one their own are capable of carrying or turning the tool.