

DIE LIFTING BOLT WITH SAFETY RING, FOR LIFTING FLANGE 2133.12.

2133.12. .1

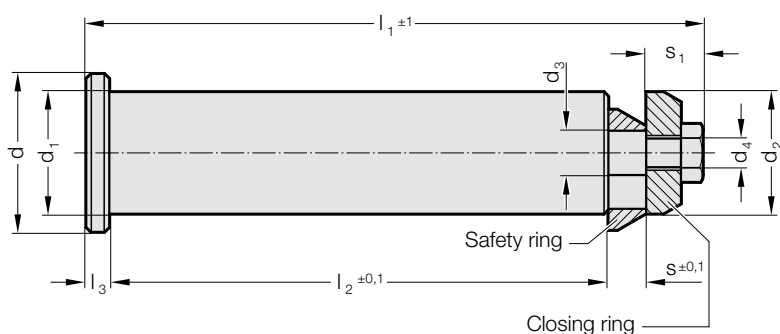

Mounting example

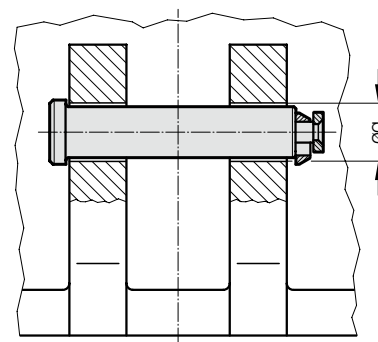

Note:

It is important to ensure that there is safety clearance on both outer sides of the cast cheeks and that there is room for installation on one side.

The lifting bolt must always be introduced from the outside of the tool towards the middle.

2133.12. .1 Die lifting bolt with safety ring, for lifting flange 2133.12.

Order No	max. carrying capacity (2 lifting flanges) [kg]*	g	d	d ₁	d ₂	d ₃	d ₄	l ₁	l ₂	l ₃	s	s ₁
2133.12.016.1	1200	16	25	15.6	15.6	6	5	102.5	77	6	8	11.5
2133.12.021.1	2000	21	30	20.6	20.6	7	6	113.5	86	6	8	13.5
2133.12.026.1	4000	26	35	25.6	25.6	9	6	128.5	100	6	9	13.5
2133.12.034.1	8000	34	43	33	33	12	8	166.5	135	6	10	15.5
2133.12.044.1	14000	44	53	43	43	16	12	210.5	175	8	12	20.5

*The maximum permissible load capacity is to be calculated such that two bolts on their own are capable of carrying or turning the tool.