

ROLLER RAIL

2198.44.

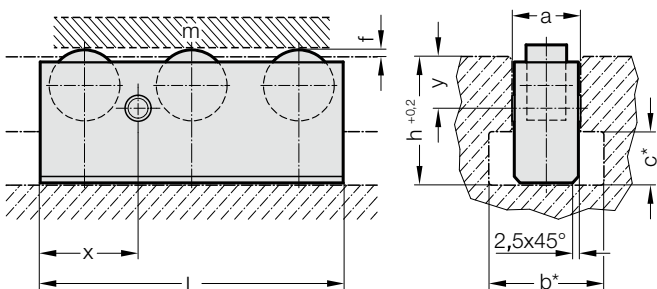

Note:

Roller rails provide double the capacity of ball bearing rails. They ensure precise linear movement of the tool.

Unlike ball bearing rails, roller rails can be used in tool base plates, i.e. installed upside down.

* T-shaped grooves are not absolutely necessary.

2198.44. Roller rail

Order No	a	Load capacity m [daN]	L	Number of rollers	Roller diameter	f	b*	c*	h	x	y
2198.44.18.105	18	150	105	3	10	1.5	30	12	30	35	14.5
2198.44.18.140	18	200	140	4	10	1.5	30	12	30	35	14.5
2198.44.18.175	18	250	175	5	10	1.5	30	12	30	35	14.5
2198.44.18.210	18	300	210	6	10	1.5	30	12	30	35	14.5
2198.44.18.280	18	400	280	8	10	1.5	30	12	30	35	14.5
2198.44.18.350	18	500	350	10	10	1.5	30	12	30	35	14.5
2198.44.22.120	22	240	120	3	13	1.5	37	16	38	40	14.5
2198.44.22.160	22	320	160	4	13	1.5	37	16	38	40	14.5
2198.44.22.200	22	400	200	5	13	1.5	37	16	38	40	14.5
2198.44.22.240	22	480	240	6	13	1.5	37	16	38	40	14.5
2198.44.22.320	22	640	320	8	13	1.5	37	16	38	40	14.5
2198.44.22.400	22	800	400	10	13	1.5	37	16	38	40	14.5
2198.44.28.135	28	380	135	3	16	1.5	46	20	48	45	19
2198.44.28.180	28	500	180	4	16	1.5	46	20	48	45	19
2198.44.28.225	28	630	225	5	16	1.5	46	20	48	45	19
2198.44.28.270	28	750	270	6	16	1.5	46	20	48	45	19
2198.44.28.360	28	1000	360	8	16	1.5	46	20	48	45	19
2198.44.28.450	28	1250	450	10	16	1.5	46	20	48	45	19
2198.44.36.150	36	600	150	3	19	1.5	56	25	61	50	24.5
2198.44.36.200	36	800	200	4	19	1.5	56	25	61	50	24.5
2198.44.36.250	36	1000	250	5	19	1.5	56	25	61	50	24.5
2198.44.36.300	36	1200	300	6	19	1.5	56	25	61	50	24.5
2198.44.36.400	36	1600	400	8	19	1.5	56	25	61	50	24.5
2198.44.36.500	36	2000	500	10	19	1.5	56	25	61	50	24.5