

BALL-LOCK PUNCH, BLANK, LIGHT DUTY

2202.

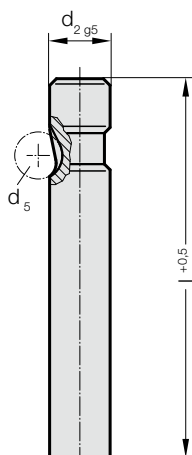

2202. Ball-Lock punch, blank, light duty

d ₂ / Order No	d ₅	l / (Order Code character)	63 (C)	71 (D)	80 (E)	90 (F)	100 (G)	110 (H)	125 (J)	140 (K)	150 (L)	175 (M)	200 (N)
6 / (1)	6		●	●	●	●	●						
10 / (2)	8		●	●	●	●	●	●					
13 / (3)	8		●	●	●	●	●	●	●	●		●	
16 / (4)	8		●	●	●	●	●	●	●	●	●	●	
20 / (5)	8		●	●	●	●	●	●	●	●	●	●	●
25 / (6)	8		●	●	●	●	●	●	●	●	●	●	●
32 / (7)	8			●	●	●	●	●	●	●	●	●	●
38 / (8)	8				●	●	●	●	●	●	●	●	●

Ordering Code (example):

2202.7G

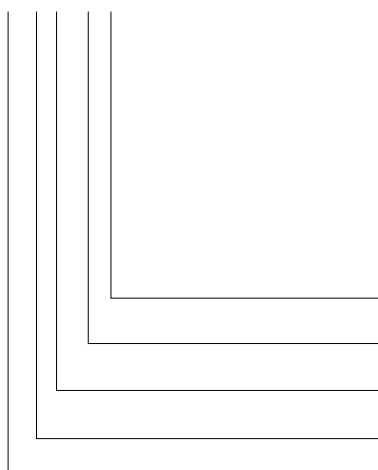

Length: l
100 mm
Diameter: d₂
32 mm
Type:
light
Execution:
blank
Punch:
without ejector pin

Order Code character
= (G)
Order No
= (7)
Order No
= (2)
Order No
= (0)
= 22

Material:

HSS
Hardness 62 ± 2 HRC

Execution:

Shaft fine ground.
Special dimensions on request.