

# SCHNELLWECHSEL-SCHNEIDSTEMPEL, ROHLING, SCHWER BELASTBAR

2203.

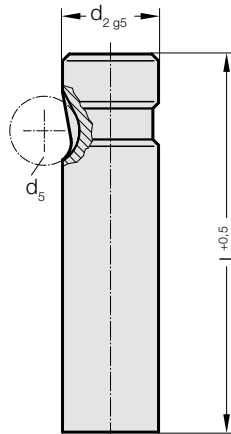

## 2203. Schnellwechsel-Schneidstempel, Rohling, schwer belastbar

d <sub>2</sub> / (Bestellziffer)	d <sub>5</sub>	l / Bestellbuchstabe	63 (C)	71 (D)	80 (E)	90 (F)	100 (G)	110 (H)	125 (J)	140 (K)	150 (L)	175 (M)	200 (N)
10 / (2)	10		●	●	●	●	●	●	●				
13 / (3)	12		●	●	●	●	●	●	●	●	●	●	
16 / (4)	12		●	●	●	●	●	●	●	●	●	●	●
20 / (5)	12		●	●	●	●	●	●	●	●	●	●	●
25 / (6)	12			●	●	●	●	●	●	●	●	●	●
32 / (7)	12			●	●	●	●	●	●	●	●	●	●
40 / (9)	12				●	●	●	●	●	●	●	●	●

### Bestell-Beispiel:

**2203.7G**

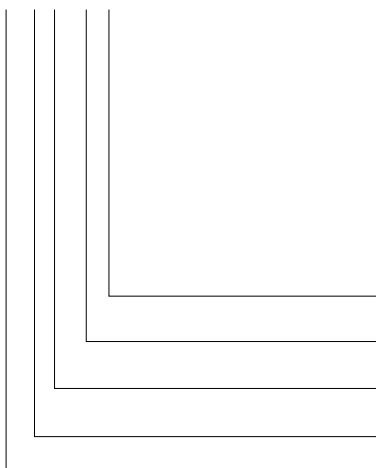

**Länge: l**  
100 mm  
**Durchmesser: d<sub>2</sub>**  
32 mm  
**Typ:**  
schwer  
**Ausführung:**  
Rohling  
**Schneidstempel:**  
ohne Abdrückstift

**Bestellbuchstabe**  
= (G)  
**Bestellziffer**  
= (7)  
**Bestellziffer**  
= (3)  
**Bestellziffer**  
= (0)  
**Bestellziffer**  
= 22

### Werkstoff:

HSS  
Härte 62 ± 2 HRC

### Ausführung:

Schaft feinstgeschliffen.  
Sonderanfertigung auf Anfrage.