

PUNCH DIN 9861 SHAPE C

225.

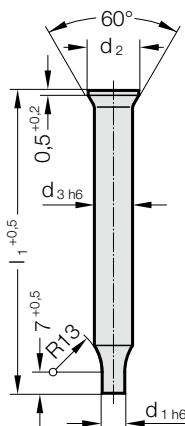

Material:

HSS
Order No 225.3.
Hardness:
Shaft 64 ± 2 HRC
Head 52 ± 3 HRC

HST
Order No 225.4.
Hardness:
Surface ≥ 950 HV 0,3
Head 52 ± 3 HRC

HZ - TIN (HSS)
Order No 225.0.
Hardness:
Surface 2300 HV 0,05
Head 52 ± 3 HRC

ASP 23 - ASP 2023
Order No 225.6.
Hardness:
Shaft 64 ± 2 HRC
Head 52 ± 3 HRC

Description of FIBRO materials for tool and die components see at the beginning of Chapter E.

Execution:

Head hot upset-forged and tempered. Shaft and head subsequently precision plunge-ground for perfect concentricity and full interchangeability with replacement punches.

Stock lengths: 71 mm.
Other lengths and diameters on request!

225. Punch DIN 9861 Shape C

d ₁	Gradation		d ₂	d ₃	l ₁
	d ₁				
0,1 - 1,5	0,05		3	2	71
1,55 - 2,95	0,05		4,5	3	71

Ordering Code (example):

Punch DIN 9861 Shape C	= 225.
Material MAT	HSS = 3.
Cutting diameter d ₁	1.55 mm = 0155.
Length l ₁	71 mm = 071
Order No	= 225. 3. 0155. 071