

PUNCHING AND EMBOSING UNIT WITH MATRIX FOR PUNCHED HOLES AND SELF TAPPING SCREWS



Material:

HSS

Execution:

The punching and embossing unit with matrix consists of:

1 x embossing die

1 x punch die

1 x matrix

Sheet metal thickness:

max. 0,6 mm = 2282.01.035/039

max. 0,8 mm = 2282.01.042

max. 0,9 mm = 2282.01.048

max. 1,0 mm = 2282.01.055/063

2282.01. Punching and embossing unit with matrix for punched holes and self tapping screws

Order No	Nominal-Ø = Thread size	d ₁	d ₂	d _{3h6}	d _{4k6}	d _{5h6}	d ₆	d ₇	d _{8h6}	d _{9k6}	l ₁	l ₂	l ₃	l ₄	l ₅
2282.01.035	B 3,5	2.75	3.2	7.5	3.75	2.7	2.7	3.1	7.5	3.75	31.3	28	74.5	71.5	60
2282.01.039	B 3,9	3.05	3.4	7.5	3.75	3	3	3.6	7.5	3.75	31.3	28	74.5	71.5	60
2282.01.042	B 4,2	3.15	3.5	8.5	4.25	3.1	3.1	3.7	8	4	31.3	28	74.5	71.5	60
2282.01.048	B 4,8	3.85	4.2	9	4.5	3.8	3.8	4.5	8	4	31.3	28	74.5	71.5	60
2282.01.055	B 5,5	4.35	4.8	9	4.5	4.3	4.3	5	8	4	31.3	28	74.5	71.5	60
2282.01.063	B 6,3	4.85	5.3	10.5	5.25	4.8	4.8	5.5	10	5	31.3	28	74.5	71.5	60

2282.01.

2282.01.xxx.1 Embossing die

2282.01.xxx.2 Punch die

2282.01.xxx.3 Bottom die

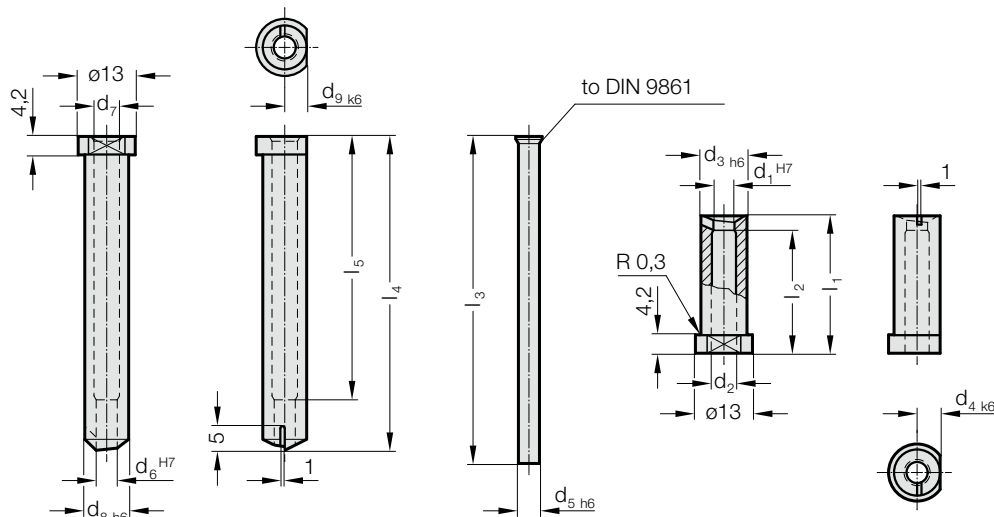

Example of application:

