

# 弹顶销, 有硬度, DIN 1530-1 A-TYP

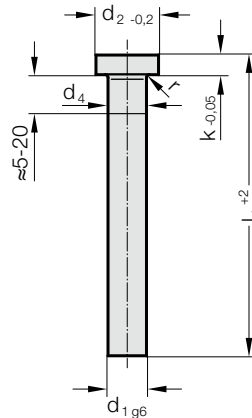

237.1.



**材料:**

WS

订购编号 237.1.

**硬度:**

杆部 60 ± 2 HRC

头部 45 ± 5 HRC

☞ 材料说明和其他材料见E章开头。

**结构:**

轴杆精密打磨, 硬化。

头部顶锻并回火。

头部下方顶锻加粗

取消, 依据制造商操作程序。

d<sub>4</sub>: 对于 d<sub>1</sub> < 5 mm, d<sub>4</sub> = d<sub>1</sub>+0.03

对于 d<sub>1</sub> ≥ 5 mm, d<sub>4</sub> = d<sub>1</sub>+0.04

对于 d<sub>1</sub> ≥ 18 mm, d<sub>4</sub> = d<sub>1</sub>+0.07

237.1. 弹顶销, 有硬度, DIN 1530-1 A-Typ

d <sub>1</sub>	d <sub>2</sub>	k	r	l <sub>1</sub>	40	63	80	100	125	160	200	250	315	400	500
1	2.5	1.2	0.2		●	●	●	●	●	●	●				
1.1	2.5	1.2	0.2		●	●	●	●	●	●	●				
1.2	2.5	1.2	0.2		●	●	●	●	●	●	●				
1.3	3	1.5	0.2		●	●	●	●	●	●	●				
1.4	3	1.5	0.2		●	●	●	●	●	●	●				
1.5	3	1.5	0.2		●	●	●	●	●	●	●				
1.6	3	1.5	0.2		●	●	●	●	●	●	●				
1.7	3	1.5	0.2		●	●	●	●	●	●	●				
1.8	3	1.5	0.2		●	●	●	●	●	●	●				
1.9	3	1.5	0.2		●	●	●	●	●	●	●				
2	4	2	0.2		●	●	●	●	●	●	●	●	●		
2.2	4	2	0.2		●	●	●	●	●	●	●	●	●		
2.5	5	2	0.3		●	●	●	●	●	●	●	●	●		
2.7	5	2	0.3		●	●	●	●	●	●	●	●	●		
3	6	3	0.3		●	●	●	●	●	●	●	●	●	●	●
3.2	6	3	0.3		●	●	●	●	●	●	●	●	●	●	●
3.5	7	3	0.3		●	●	●	●	●	●	●	●	●	●	●
3.7	7	3	0.3		●	●	●	●	●	●	●	●	●	●	●
4	8	3	0.3		●	●	●	●	●	●	●	●	●	●	●
4.2	8	3	0.3		●	●	●	●	●	●	●	●	●	●	●
4.5	8	3	0.3		●	●	●	●	●	●	●	●	●	●	●
4.7	8	3	0.3		●	●	●	●	●	●	●	●	●	●	●

**订购示例:**

弹顶销, 有硬度, DIN 1530-1 A-Typ =237.1.  
 轴径 d<sub>1</sub> 5 mm = 0500.  
 长度 l<sub>1</sub> 40 mm = 040  
 订购编号 =237.1. 0500. 040

# 弹顶销, 有硬度, DIN 1530-1 A-TYP

材料:  
WS  
订购编号 237.1.  
硬度:  
杆部  $60 \pm 2$  HRC  
头部  $45 \pm 5$  HRC

**237.1.**

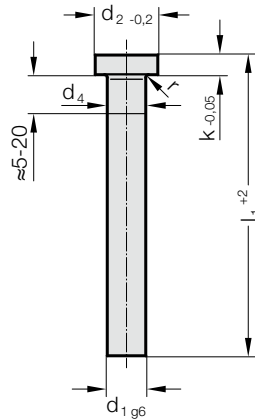

材料说明和其他材料见E章开头。

结构:  
轴杆精密打磨, 硬化。  
头部顶锻并回火。  
头部下方顶锻加粗  
取消, 依据制造商操作程序。

$d_4$ : 对于  $d_1 < 5$  mm,  $d_4 = d_1 + 0.03$   
对于  $d_1 \geq 5$  mm,  $d_4 = d_1 + 0.04$   
对于  $d_1 \geq 18$  mm,  $d_4 = d_1 + 0.07$

## 237.1. 弹顶销, 有硬度, DIN 1530-1 A-Typ

$d_1$	$d_2$	k	r	$l_1$	40	63	80	100	125	160	200	250	315	400	500	630	800
5	10	3	0.3		●	●	●	●	●	●	●	●	●	●	●	●	●
5.2	10	3	0.3					●	●	●	●	●	●	●	●		
5.5	10	3	0.3					●	●	●	●	●	●	●	●		
6	12	5	0.5		●	●	●	●	●	●	●	●	●	●	●	●	●
6.2	12	5	0.5					●	●	●	●	●	●	●	●	●	●
6.5	12	5	0.5					●	●	●	●	●	●	●	●	●	●
7	12	5	0.5					●	●	●	●	●	●	●	●	●	●
8	14	5	0.5			●	●	●	●	●	●	●	●	●	●	●	●
8.2	14	5	0.5					●	●	●	●	●	●	●	●	●	●
8.5	14	5	0.5					●	●	●	●	●	●	●	●	●	●
9	14	5	0.5					●	●	●	●	●	●	●	●	●	●
10	16	5	0.5				●	●	●	●	●	●	●	●	●	●	●
10.2	16	5	0.5					●	●	●	●	●	●	●	●	●	●
10.5	16	5	0.5					●	●	●	●	●	●	●	●	●	●
11	16	5	0.5					●	●	●	●	●	●	●	●	●	●
12	18	7	0.8				●	●	●	●	●	●	●	●	●	●	●
12.2	18	7	0.8					●	●	●	●	●	●	●	●	●	●
12.5	18	7	0.8					●	●	●	●	●	●	●	●	●	●
14	22	7	0.8				●	●	●	●	●	●	●	●	●	●	●
16	22	7	0.8					●	●	●	●	●	●	●	●	●	●
18	24	7	0.8					●	●	●	●	●	●	●	●	●	●
20	26	8	1					●	●	●	●	●	●	●	●	●	●

### 订购示例:

弹顶销, 有硬度, DIN 1530-1 A-Typ =237.1.  
轴径  $d_1$  5 mm = 0500.  
长度  $l_1$  40 mm = 040  
订购编号 =237.1. 0500. 040