

MATRIX WITH COLLAR, DIN 9845 SHAPE B

261.

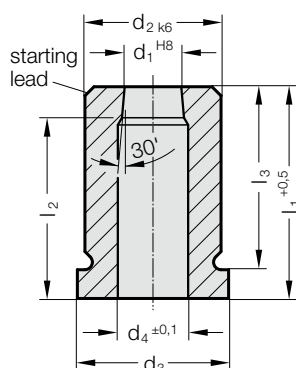

Material:

HSS

Order No 261.3.

Hardness 62 ± 2 HRC

 Description of FIBRO materials for tool and die components see at the beginning of Chapter E.

Execution:

Diameters d_1 , d_2 and face surfaces ground.

d_4 : For $d_1 \leq 2$ mm, $d_4 = d_1 + 0,3$

For $d_1 = 2,1$ mm to 4,0 mm, $d_4 = d_1 + 0,5$

For $d_1 = 4,1$ mm to 8,0 mm, $d_4 = d_1 + 0,7$

For $d_1 \geq 8,1$ mm, $d_4 = d_1 + 1$

Other diameters on request.

261. Matrix with collar, DIN 9845 Shape B

d_1	Gradation								
	d_1	d_2	d_3	l_1	20	28	l_1	20	28
0,5 - 1	0.1	5	7	l_2	18		l_3	16	
1,1 - 2	0.1	6	8		17	25		16	24
2,1 - 3	0.1	7	9		17	25		16	24
3,1 - 4	0.1	8	10		17	25		16	24
4,1 - 5	0.1	10	12		16	24		16	24
5,1 - 6	0.1	12	14		16	24		16	24
6,1 - 8	0.1	15	17		16	24		16	24
8,1 - 10	0.1	18	20		16	24		16	24
10,1 - 12	0.1	22	24		15	23		16	24
12,1 - 15	0.1	26	28		15	23		16	24
15,1 - 18	0.1	30	32			23			24

Ordering Code (example):

Matrix with collar, DIN 9845 Shape B = 261.3.

Cutting diameter d_1 5.1 mm = 0510.

Length l_1 20 mm = 020

Order No = 261.3.0510.020