

BALL-LOCK PUNCH, STEPPED, RECTANGULAR, WITH EJECTOR PIN, HEAVY DUTY

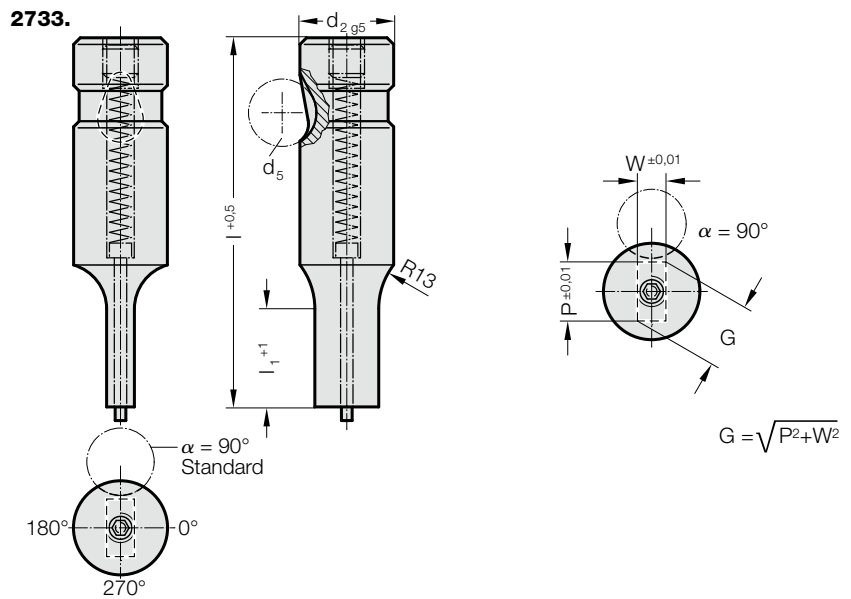

2733. Ball-Lock punch, stepped, rectangular, with ejector pin, heavy duty

d ₂ / Order No	d ₅	W _{min}	G _{max}	l ₁ / Order No	l (Order Code character)	63 (C)	71 (D)	80 (E)	90 (F)	100 (G)	110 (H)	125 (J)
10 / (2)	10	4	9.9	13(1) 19(2)		●	●	●	●	●		
13 / (3)	12	6	12.9	13(1) 19(2)		●	●	●	●	●	●	●
16 / (4)	12	8	15.9	13(1) 19(2) 25(3)		●	●	●	●	●	●	●
20 / (5)	12	10	19.9	13(1) 19(2) 25(3)		●	●	●	●	●	●	●
25 / (6)	12	12	24.9	13(1) 19(2) 25(3)			●	●	●	●	●	●
32 / (7)	12	16	31.9	13(1) 19(2) 25(3)			●	●	●	●	●	●
40 / (9)	12	19	39.9	19(2) 25(3) 30(4)				●	●	●	●	●

*at d₂ = 16/ 20 and l = 63; l_{1 max.} = 19

Material:

HSS
Hardness 62 ± 2 HRC

Execution:

Shaft and punch shape fine ground.
Special dimensions on request.

Note:

With kerf ≤ 0.04 mm, FIBRO rounds off sharp edges if the punch and piercing die bush are ordered together. This reduces the fitting time and the risk of an edge break during operation.

Ordering Code (example):

2733.7F2.1420.1250.B

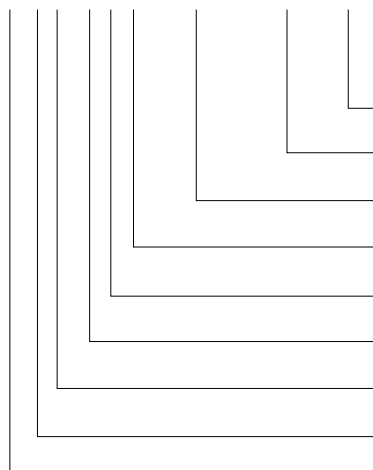

Angle: 90°
Shape: rectangular, Width W
W = 12,50 mm
Shape: rectangular, Length P
P = 14,20 mm
Punch cutting length: l₁
19 mm
Length: l
90 mm
Diameter: d₂
32 mm
Type: heavy
Execution: rectangular
Punch: with ejector pin

Order Code character = (B)
Order Code character = (F)
Order No = 1250
Order Code character = (2)
Order No = 1420
Order Code character = (7)
Order No = 1250
Order Code character = (B)