

# Rod Ends Series E

## Series EA...EW-2RS

Rod end series E with male thread made of heat-treated steel, galvanized, with EW spherical plain bearing

For use with high, unidirectionally/variably acting loads and low installation width

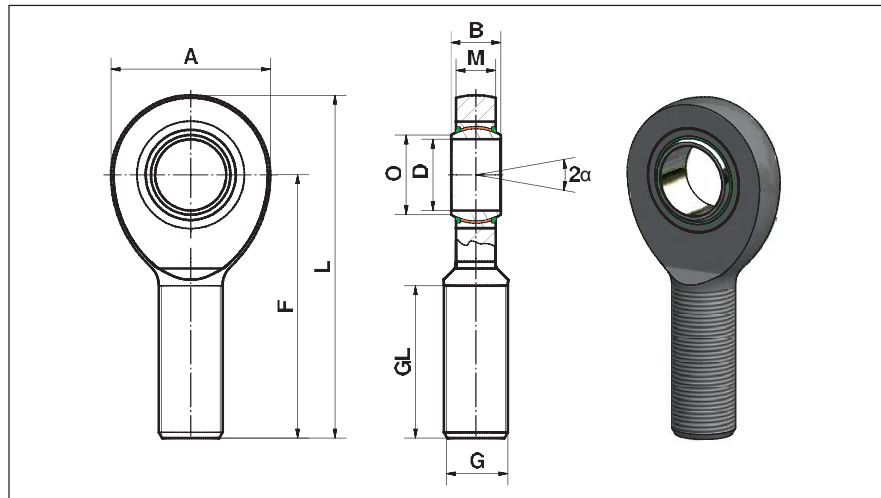

Size (D)	B	M	A	F	L	O	G	GL	Static load ratings C <sub>0</sub> kN	Dynamic load ratings C kN	Tilting angle α	Weight g
17	14	11	46	69	92,0	20,7	M16	36	54,0	48,7	10	190
20	16	13	53	78	104,5	24,1	M20x1,5	43	62,5	67,5	9	320
25	20	17	64	94	126,0	29,3	M24x2	53	92,0	127,0	7	560
30	22	19	73	110	146,5	34,2	M30x2	65	124,0	165,0	6	890
35	25	21	82	140	181,0	39,7	M36x3	82	144,0	210,0	6	1.400
40	28	23	92	150	196,0	45,0	M39x3	86	178,0	277,0	7	1.800
45	32	27	102	163	214,0	50,7	M42x3	94	263,0	360,0	7	2.610
50	35	30	112	185	241,0	55,9	M45x3	107	320,0	442,0	6	3.450
60	44	38	135	210	277,5	66,8	M52x3	115	497,0	690,0	6	5.900
70	49	42	160	235	315,0	77,8	M56x4	125	566,0	885,0	6	8.200
80	55	47	180	270	360,0	89,4	M64x4	140	752,0	1.125,0	6	12.000

⚠ Please note: For rod ends with FLUROGLIDE®, the dynamic load rating of the bearing is higher than the static load capacity C<sub>0</sub> of the rod end!

### Materials:

**Housing:** Heat-treated steel to C45, forged, galvanized

**Bearing:** Maintenance free spherical plain bearing with sealing GE...EW -2RS (see page 17)

Please note that the numbers pointed off on the pages 17 to 23 and 25 in the data sheets, signalise a thousands place. And the numbers with thousands separators (comma) signalise a decimal point.