

Axial-Gelenklager

Serie GE...AWE

Axial-Gelenklager,
Gleitpaarung Hartchrom/
FLUROGLIDE®,
wartungsfrei

Für den Einsatz bei hoher
Axialbelastung

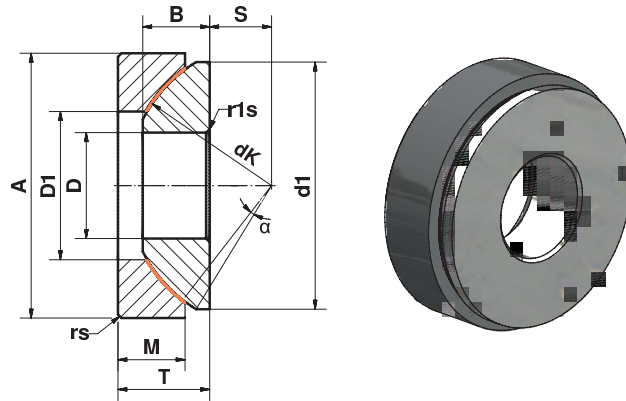

Größe (D)	B	M	A	T	S	r _s , r _{1s} min	d ₁ min	D1	d _k	axiale Tragzahl kN		Kipp- winkel α ≈	Stück- gewicht g
										statisch C ₀	dynamisch C		
10 ⁰ _{-0,008}	7,5	7,0	30 ⁰ _{-0,009}	9,5 ^{+0,25} _{-0,40}	7,0	0,6	27,5	17,0	32	146	88	5,0	36
12 ⁰ _{-0,008}	9,5	9,3	35 ⁰ _{-0,011}	13,0 ^{+0,25} _{-0,40}	8,0	0,6	32,0	20,0	38	195	117	5,0	72
15 ⁰ _{-0,008}	11	10,8	42 ⁰ _{-0,011}	15,0 ^{+0,25} _{-0,40}	10,0	0,6	39,0	24,5	46	278	167	6,0	108
17 ⁰ _{-0,008}	11,8	11,2	47 ⁰ _{-0,011}	16,0 ^{+0,25} _{-0,40}	11,0	0,6	43,5	28,5	52	350	210	4,0	137
20 ⁰ _{-0,010}	14,5	13,8	55 ⁰ _{-0,013}	20,0 ^{+0,25} _{-0,40}	12,5	1,0	50,0	34,0	60	410	246	5,0	246
25 ⁰ _{-0,010}	16,5	16,7	62 ⁰ _{-0,013}	22,5 ^{+0,25} _{-0,40}	14,0	1,0	58,5	35,0	68	718	431	5,0	415
30 ⁰ _{-0,010}	19,0	19,0	75 ⁰ _{-0,013}	26,0 ^{+0,25} _{-0,40}	17,5	1,0	70,0	44,5	82	920	552	5,0	614
35 ⁰ _{-0,012}	22,0	20,7	90 ⁰ _{-0,015}	28,0 ^{+0,25} _{-0,40}	22,0	1,0	84,0	52,5	98	1.340	804	5,0	973
40 ⁰ _{-0,012}	27,0	21,5	105 ⁰ _{-0,015}	32,0 ^{+0,25} _{-0,40}	24,5	1,0	97,0	59,5	114	1.789	1.073	6,0	1.590
45 ⁰ _{-0,012}	31,0	25,5	120 ⁰ _{-0,015}	36,5 ^{+0,25} _{-0,40}	27,5	1,0	110,0	68,5	128	2.263	1.357	6,0	2.240
50 ⁰ _{-0,012}	33,0	30,5	130 ⁰ _{-0,018}	42,5 ^{+0,25} _{-0,50}	30,0	1,0	120,0	71,0	139	2.836	1.702	6,0	3.140
60 ⁰ _{-0,015}	37,0	34,0	150 ⁰ _{-0,018}	45,0 ^{+0,25} _{-0,50}	35,0	1,0	140,0	86,5	160	3.790	2.274	6,0	4.630
70 ⁰ _{-0,015}	42,0	36,5	160 ⁰ _{-0,025}	50,0 ^{+0,25} _{-0,50}	35,0	1,0	153,0	95,5	176	4.887	2.932	3,0	5.370
80 ⁰ _{-0,015}	43,5	38,0	180 ⁰ _{-0,025}	50,0 ^{+0,25} _{-0,50}	42,5	1,0	172,0	109,0	197	5.908	3.545	4,0	6.910
100 ⁰ _{-0,020}	51,0	46,0	210 ⁰ _{-0,030}	59,0 ^{+0,25} _{-0,60}	45,0	1,1	198,0	134,0	222	7.018	4.210	4,0	11.000
120 ⁰ _{-0,020}	53,5	50	230 ⁰ _{-0,030}	64,0 ^{+0,25} _{-0,60}	52,5	1,1	220,0	155,0	250	8.162	4.897	3,0	14.000
140 ⁰ _{-0,025}	61,0	54,0	260 ⁰ _{-0,035}	72,0 ^{+0,35} _{-0,70}	52,5	1,5	243,0	177,0	274	9.372	5.623	3,0	19.100
160 ⁰ _{-0,025}	66,0	58,0	290 ⁰ _{-0,035}	77,0 ^{+0,35} _{-0,70}	65,0	1,5	271,0	200,0	313	11.680	7.008	2,0	25.000
180 ⁰ _{-0,025}	74,0	62,0	320 ⁰ _{-0,040}	86,0 ^{+0,35} _{-0,70}	67,5	1,5	299,0	225,0	340	12.364	7.418	4,0	32.800
200 ⁰ _{-0,030}	80,0	66,0	340 ⁰ _{-0,040}	87,0 ^{+0,35} _{-0,80}	70,0	1,5	320,0	247,0	365	15.350	9.210	1,0	35.400
220 ⁰ _{-0,030}	82,0	67,0	370 ⁰ _{-0,040}	97,0 ^{+0,35} _{-0,80}	75,0	1,5	350,0	265,5	388	14.119	8.471	7,0	44.700
240 ⁰ _{-0,030}	87,0	73,0	400 ⁰ _{-0,040}	103,0 ^{+0,35} _{-0,80}	77,5	1,5	382,0	294,0	420	17.176	10.305	6,0	56.900
260 ⁰ _{-0,035}	95,0	80,0	430 ⁰ _{-0,045}	115,0 ^{+0,35} _{-0,80}	82,5	1,5	409,0	317,0	449	18.019	10.811	7,0	71.300
280 ⁰ _{-0,035}	100,0	85,0	460 ⁰ _{-0,045}	110,0 ^{+0,35} _{-0,80}	80,0	3,0	445,0	337,0	480	28.561	17.136	4,0	84.700
300 ⁰ _{-0,035}	100,0	90,0	480 ⁰ _{-0,045}	110,0 ^{+0,35} _{-0,80}	80,0	3,0	460,0	356,0	490	28.809	17.285	3,5	88.900

Werkstoffe:

Gehäusescheibe: Wälzlagerstahl 100Cr6, gehärtet und phosphatiert mit eingeklebtem FLUROGLIDE®

Innenscheibe: Wälzlagerstahl 100Cr6, gehärtet, geschliffen, poliert, hartverchromt

Auf Anfrage in rostfreier Ausführung