



DryLin® R | Linear Plain Bearing RJUI-01 | Inch



Special properties:

- Closed, anodized aluminium housing
- Dimensions equivalent to standard recirculating ball bearings
- Equipped with JUI-01 liner made of iglidur® J
- Recommended housing H7
- Recommended tolerance for the shaft: h6 - h10
- Secured by circlips (not included in delivery)

Inch

DryLin® R

Phone +49 - 22 03 - 96 49-145

Fax +49 - 22 03 - 96 49-334

igus® GmbH
51147 Cologne

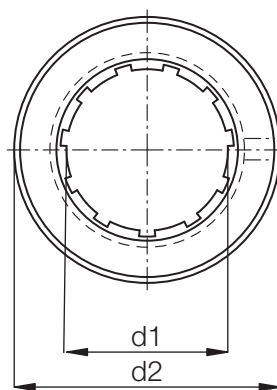
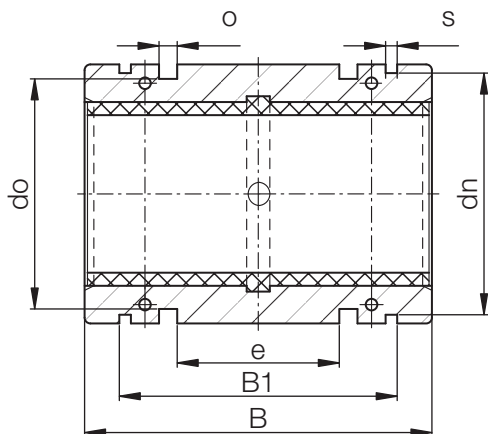

Dimensions [Inch]

Part No.	Ø Shaft [Inch]	Tolerance** [Inch]	d2 [inch] h7	B [inch] h10	B1 [inch] H10	s [inch] H10	dn [inch] h10	e [inch]	o [inch] -0,004	do [inch]
RJZI-01-04*	1/4	0,0016-0,0032	,5000	,7500	,5190	,0410	,4670	,125	,0800	,3990
RJUI-01-06	3/8	0,0016-0,0032	,6250	,8750	,6440	,0410	,5870	,243	,0800	,5240
RJUI-01-08	1/2	0,0016-0,0032	,8750	1,2500	,9790	,0520	,8200	,281	,1250	,7120
RJUI-01-10	5/8	0,0016-0,0032	1,1250	1,5000	1,1240	,0620	1,0600	,312	,1250	,9620
RJUI-01-12	3/4	0,0016-0,0032	1,2500	1,6250	1,1860	,0620	1,1770	,312	,1250	1,0870
RJUI-01-16	1	0,0016-0,0032	1,5625	2,2500	1,7730	,0740	1,4710	,500	,1250	1,3990
RJUI-01-20	1-1/4	0,0020-0,0041	2,0000	2,6250	2,0230	,0740	1,8890	,625	,1250	1,8370
RJUI-01-24	1-1/2	0,0020-0,0041	2,3750	3,0000	2,4400	,0950	2,2410	,650	,1620	2,1520
RJUI-01-32	2	0,0024-0,0051	3,0000	4,0000	3,2220	,1110	2,8390	1,000	,1890	2,7750

* Nominal diameters under 3/8 inches are delivered with pressfit sleeve bearings

** According to igus® testing method ► Page 64.37

Internet www.igus.de
E-mail info@igus.de