

Bestellschlüssel

Teilenummer	Gewinde- abmessung	Optionen
DST-LS-10x50-R-xx-ES		

dryspin® Technologie	Spindel	Aussen-Ø [mm]	Steigung P [mm]	Drehrichtung	Länge	Spindelmaterial
-------------------------	---------	---------------	-----------------	--------------	-------	-----------------

Optionen

Länge in [mm]:

frei wählbar bis max. siehe
Liefertabelle

Abmessungen [mm]

Gewinde	Ø	Steigung P	max. Länge L	Art.-Nr.
Ds6,35x2,54	6,35	2,54	1.000	DST-LS-6.35x2.54-R-ES
Ds6,35x5,08	6,35	5,08	1.500	DST-LS-6.35x5.08-R-ES
Ds6,35x12,7	6,35	12,7	1.500	DST-LS-6.35x12.7-R-ES
Ds6,35x25,4	6,35	25,4	1.000	DST-LS-6.35x25.4-R-ES
Ds10x12	10	12	3.000	DST-LS-10x12-R-ES
Ds10x25	10	25	3.000	DST-LS-10x25-R-ES
Ds10x25	10	25	3.000	DST-LS-10x25-L-ES
Ds10x50	10	50	3.000	DST-LS-10x50-R-ES
Ds10x50	10	50	3.000	DST-LS-10x50-L-ES
Ds14x25	14	25	3.000	DST-LS-14x25-R-ES
Ds14x30	14	30	3.000	DST-LS-14x30-R-ES
Ds16x35	16	35	3.000	DST-LS-16x35-R-ES
Ds18x40	18	40	3.000	DST-LS-18x40-R-ES
Ds18x80	18	80	3.000	DST-LS-18x80-R-ES
Ds20x60	20	60	3.000	DST-LS-20x60-R-ES
Ds20x90	20	90	3.000	DST-LS-20x90-R-ES

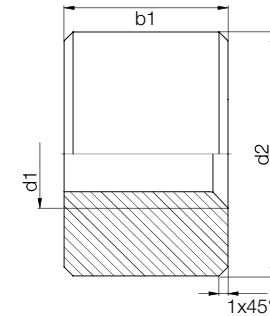

Bestellschlüssel

Teilenummer	d2	b1	Gewinde
DST-JSRM-1413DS10x12			

dryspin® Technologie	iglidur® J	Form S	Rechtsgewinde	Metrisch	Aussen-Ø [mm]	Länge [mm]	Gewinde-Typ	Gewinde-Ø [mm]	Steigung P [mm]
-------------------------	------------	--------	---------------	----------	---------------	------------	-------------	----------------	-----------------

Technische Daten und Abmessungen [mm]

Gewinde	d1	d2	b1	Flächen- traganteil [mm²]	Max stat. F axial [N]	Art.-Nr.
Ds6,35x2,54	6,35	14	13	172	152	DST-JSRM-1413DS6.35x2.54
Ds6,35x5,08	6,35	14	13	201	152	DST-JSRM-1413DS6.35x5.08
Ds6,35x12,7	6,35	14	13	–	–	DST-JSRM-1413DS6.35x12.7
Ds6,35x25,4	6,35	14	13	75	152	DST-JSRM-1413DS6.35x25.4
Ds10x12	10	22	20	302	755	DST-JSRM-2220DS10x12
Ds10x25	10	22	20	249	623	DST-JSRM-2220DS10x25
Ds10x25	10	22	20	249	623	DST-JSLM-2220DS10x25
Ds10x50	10	22	20	146	365	DST-JSRM-2220DS10x50
Ds10x50	10	22	20	146	365	DST-JSLM-2220DS10x50
Ds14x25	14	30	27	448	1.120	DST-JSRM-3027DS14x25
Ds14x30	14	30	27	373	932	DST-JSRM-3027DS14x30
Ds16x35	16	36	32	680	1.700	DST-JSRM-3632SD16x35
Ds18x40	18	40	36	802	2.005	DST-JSRM-4036DS18x40
Ds18x80	18	40	36	601	1.503	DST-JSRM-4036DS18x80
Ds20x60	20	45	40	1.023	2.557	DST-JSRM-4540DS20x60
Ds20x90	20	45	40	682	1.705	DST-JSRM-4540DS20x90