

Technical data and dimensions [mm]

Part No.	Mk	Vx	Kx	Vz	Kz	Dk	Min. holding strength ⁶⁷⁾	Min. tightening torque
WHKA-06 ⁶⁶⁾	M6	34.5	21.5	8	28	20	30 N	0.8 Nm
WHKA-10 ⁶⁶⁾	M6	50	33	8	28	20	30 N	0.8 Nm
WHKA-16 ⁶⁶⁾	M8	72	41	10	31	28	60 N	1.5 Nm
WHKA-20 ⁶⁶⁾	M8	90	62	10	31	28	70 N	1.5 Nm
WHKA-25 ⁶⁶⁾	M8	96	65	12	31	28	70 N	1.5 Nm

⁶⁶⁾ The manual clamp is also available assembled as a complete carriage (suffix "-HKA", order example WW-10-40-10-HKA) ► Complete carriage WW, Page 808

⁶⁷⁾ Condition: dry rail surface

Aluminium manual clamp

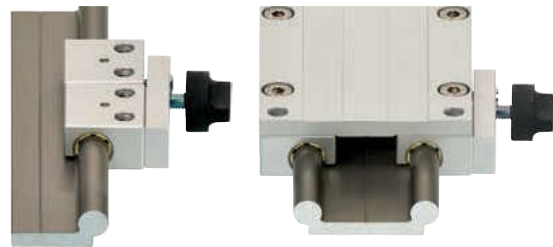

Technical data and dimensions [mm]

Part No.	Mk	Vx	Kx	Vz	Kz	Dk	Min. holding strength ⁶⁷⁾	Min. tightening torque
WHKA-06-AL ⁶⁶⁾	M6	34.5	21.5	8	28	20	30 N	0.8 Nm
WHKA-10-AL ⁶⁶⁾	M6	50	33	8	28	20	30 N	0.8 Nm
WHKA-16-AL ⁶⁶⁾	M8	72	41	10	31	28	60 N	1.5 Nm
WHKA-20-AL ⁶⁶⁾	M8	90	62	10	31	28	70 N	1.5 Nm
WHKA-25-AL ⁶⁶⁾	M8	96	65	12	31	28	70 N	1.5 Nm

⁶⁶⁾ The manual clamp is also available assembled as a complete carriage (suffix "-AL-HKA", order example: WW-10-40-10-HKA) ► Complete carriage WW, Page 808

⁶⁷⁾ Condition: dry rail surface

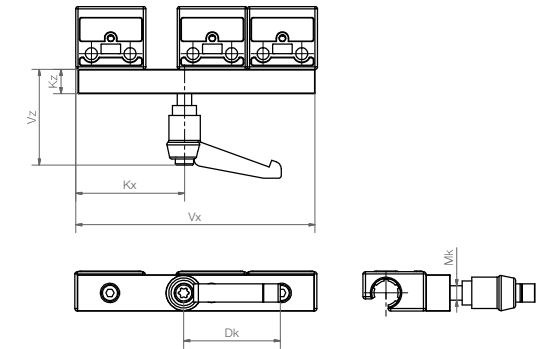

Technical data and dimensions [mm]

Part No.	Mk	Vx	Kx	Vz	Kz	Dk	Min. holding strength ⁶⁷⁾	Min. tightening torque
WHKD-1010 ⁶⁹⁾	M6	100	45	40	10	40	70 N	2.5 Nm
WHKD-1015 ⁶⁹⁾	M6	150	95	40	10	40	70 N	2.5 Nm
WHKD-1615 ⁶⁹⁾	M8	150	81	40	12	40	90 N	3.5 Nm
WHKD-1620 ⁶⁹⁾	M8	200	131	10	12	40	90 N	3.5 Nm
WHKD-2015 ⁶⁹⁾	M8	150	63	40	12	40	90 N	3.5 Nm
WHKD-2020 ⁶⁹⁾	M8	200	113	40	12	40	90 N	3.5 Nm

⁶⁹⁾ The hand clamp WHKD is available assembled in the following complete carriages: WW-10-40-10-HKD, WW-20-80-15-HKD. Dimensions ► Complete carriage WW, Page 808

⁶⁷⁾ Condition: dry rail surface