

Accessories: manual clamp

drylin® W manual clamping,
for simple positioning tasks

- Cost-efficient option
- Universally applicable
- Clamping force based on tightening torque
- Clamping by friction locking

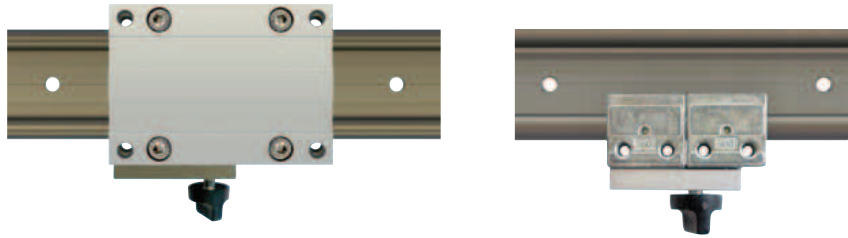
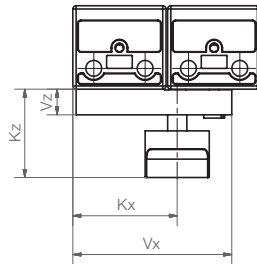
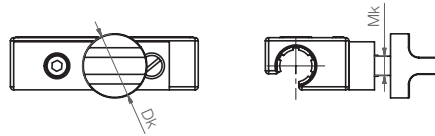

drylin® W Accessories – Load Data and Dimensions [mm]

Part number	Mk	Vx	Kx	Vz	Kz	Dk	Min. holding strength**	Min. tightening torque
WHKA-10*	M6	50	33	8	28	20	30 N	0.8 Nm
WHKA-16*	M8	72	32	10	31	26	60 N	1.5 Nm
WHKA-20*	M8	90	29	10	31	26	70 N	1.5 Nm

* Manual clamp is also available as complete carriage (suffix HKA, order example WW-10-40-10-HKD)
▶ complete carriage WW, page 963

** Condition: dry rail surface

Hint:

The creep behavior of the clamped plastic causes a slackening in clamping force over time (up to 70 %). Therefore safety-related parts should not be clamped.

 delivery from stock
time

 prices price list online
www.igus.eu/eu/drylinW

 order key
complete ▶ page 972

Accessories: manual clamp

drylin® W manual clamping
for high holding strength

- Available as single-part or assembled to guide carriage
- Clamping force based on tightening torque
- Clamping by friction locking

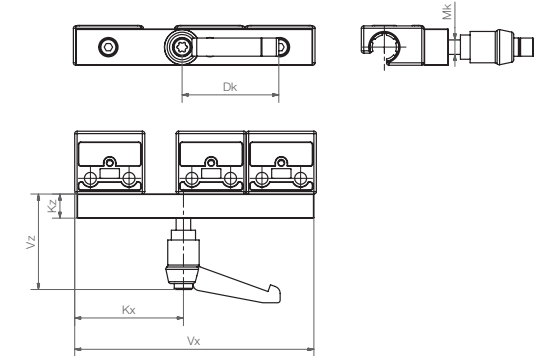

drylin® W Accessories – Load Data and Dimensions [mm]

Part number	Mk	Vx	Kx	Vz	Kz	Dk	Min. holding strength**	Min. tightening torque
WHKD-1010*	M6	100	45	40	10	40	70 N	2.5 Nm
WHKD-1015*	M6	150	95	40	10	40	70 N	2.5 Nm
WHKD-1615*	M8	150	81	40	12	40	90 N	3.5 Nm
WHKD-1620*	M8	200	131	10	12	40	90 N	3.5 Nm
WHKD-2015*	M8	150	63	40	12	40	90 N	3.5 Nm
WHKD-2020*	M8	200	113	40	12	40	90 N	3.5 Nm

* Manual clamp is also available as complete carriage (suffix HKA, order example WW-10-40-10-HKD)
▶ complete carriage WW, page 963

** Condition: dry rail surface

Hint:

The creep behavior of the clamped plastic causes a slackening in clamping force over time (up to 70 %). Therefore safety-related parts should not be clamped.

 delivery from stock
time

 prices price list online
www.igus.eu/eu/drylinW

 order key
complete ▶ page 972