

Double rail, reduced weight

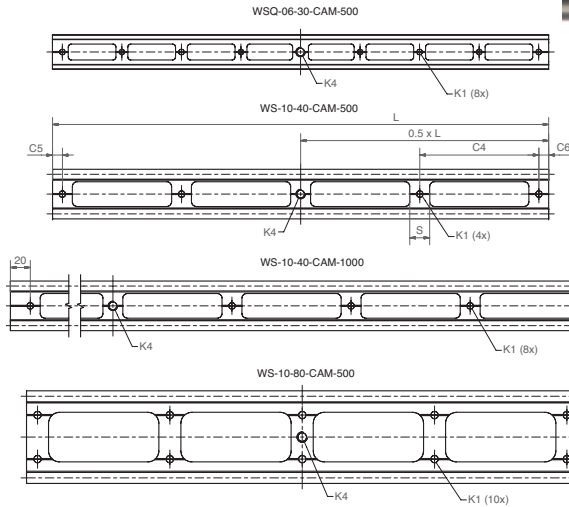
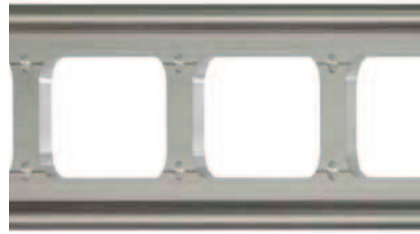

- 30% weight reduction by machined recesses
- Sizes: 0630, 1040 und 1080
- Lubrication free, quiet and light
- Standard lengths from stock
- Matching housing bearing and carriage made of plastic, aluminum, zinc die cast or stainless steel

drylin® W Guide Rail – Dimensions [mm]

Part number	Identic Profile	L	C4	C5	C6	S	K1 for Screw DIN 192	K4	Weight [g]
WSQ-06-30-CAM-500	WSQ-06-30	500	60	10	10	12	M5	3/8" 16-UNC*	159
WS-10-40-CAM-500	WS-10-40	500	120	10	10	20	M6	3/8" 16-UNC*	353
WS-10-40-CAM-1000	WS-10-40	1,000	120	20	20	20	M6	3/8" 16-UNC*	706
WS-10-80-CAM-500	WS-10-80	500	120	10	10	20	M6	3/8" 16-UNC*	482

* UNC = Unified National Coarse, anglo-saxon standard for screws and threads



Application example: Camera slider with standard rail and carriage
▶ www.igus.eu/camera

delivery from stock time

prices price list online www.igus.eu/eu/drylinW

order key complete ▶ page 972

Slider-Rail

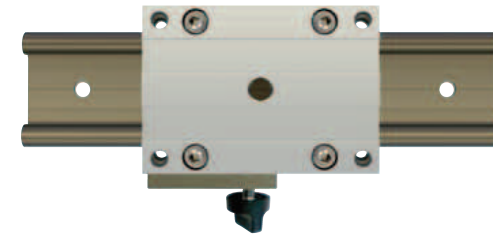

- Wear-resistant, smooth and quiet motion
- Adjustable brake level by the turn-to-fit function
- Lubricant-free
- Easy and fast assembly
- Other dimensions as standard rails WSQ ▶ page 958 and WS ▶ page 962

Technical Options:

- Adjustable housing bearing
- Manual clamp (WW...-HKA ▶ page 968)

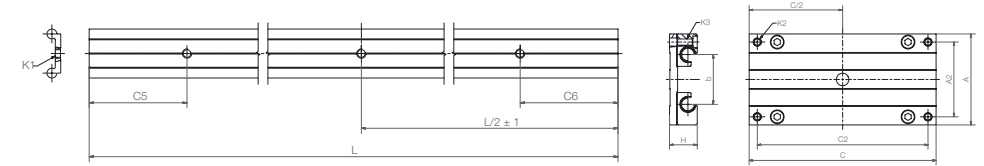

drylin® W Special rails with 3 holes, 3/8" thread
Dimensions [mm]

Part number	Size	L	C5 ± 1	C6 ± 1	Weight [kg/m]
WSQ-06-30-SL-1000	06	1,000	100	100	0.45
WSQ-06-30-SL-1500	06	1,500	100	100	0.45
WS-10-40-SL-1000	10	1,000	100	100	1.00
WS-10-40-SL-1500	10	1,500	100	100	1.00
WS-10-80-SL-1000	10	1,000	100	100	1.50
WS-10-80-SL-1500	10	1,500	100	100	1.50
WS-16-60-SL-1000	16	1,000	100	100	1.96
WS-16-60-SL-1500	16	1,500	100	100	1.96
WS-20-80-SL-1000	20	1,000	100	100	3.30
WS-20-80-SL-1500	20	1,500	100	100	3.30

drylin® W Complete carriage with ø10 mm through hole for 3/8" thread
Dimensions [mm]

Part number	Size	C	A	Part number	Size	C	A
WW-06-30-06-SL	06	60	54	WW-16-60-10-SL**	16	100	104
WW-06-30-08-SL	06	80	54	WW-16-60-15-SL**	16	150	104
WW-06-30-10-SL	06	100	54	WW-16-60-20-SL**	16	200	104
WW-10-40-10-SL**	10	100	73	WW-20-80-15-SL**	20	150	134
WW-10-40-15-SL**	10	150	73	WW-20-80-20-SL**	20	200	134
WW-10-40-20-SL**	10	200	73	WW-20-80-25-SL**	20	250	134
WW-10-80-10-SL**	10	100	107				
WW-10-80-15-SL**	10	150	107				
WW-10-80-20-SL**	10	200	107				

* optional with integrated manual clamp (add suffix "-HKA")

** optional with adjustable "Turn-To-Fit" bearing (Order example: WWE-...)

Accessories: manual clamp

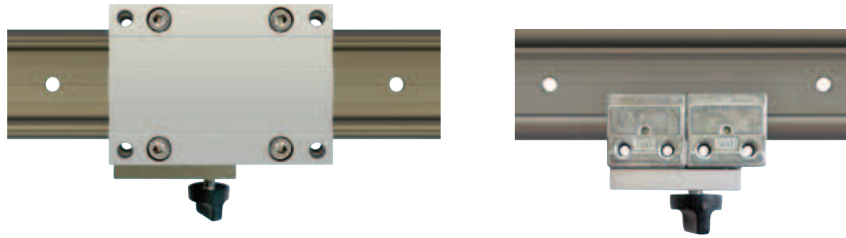
drylin® W manual clamping,
for simple positioning tasks

- Cost-efficient option
- Universally applicable
- Clamping force based on tightening torque
- Clamping by friction locking

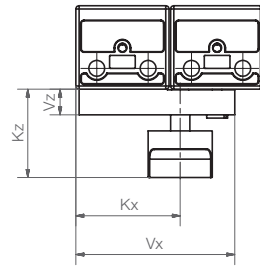
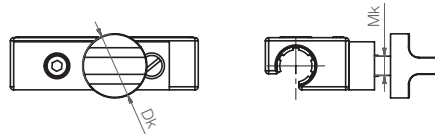

drylin® W Accessories – Load Data and Dimensions [mm]

Part number	Mk	Vx	Kx	Vz	Kz	Dk	Min. holding strength**	Min. tightening torque
WHKA-10*	M6	50	33	8	28	20	30 N	0.8 Nm
WHKA-16*	M8	72	32	10	31	26	60 N	1.5 Nm
WHKA-20*	M8	90	29	10	31	26	70 N	1.5 Nm

* Manual clamp is also available as complete carriage (suffix HKA, order example WW-10-40-10-HKD)
▶ complete carriage WW, page 963

** Condition: dry rail surface

Hint:

The creep behavior of the clamped plastic causes a slackening in clamping force over time (up to 70 %). Therefore safety-related parts should not be clamped.

 **delivery** from stock
time

 **prices** price list online
www.igus.eu/eu/drylinW

 **order key**
complete ▶ page 972

Accessories: manual clamp

drylin® W manual clamping
for high holding strength

- Available as single-part or assembled to guide carriage
- Clamping force based on tightening torque
- Clamping by friction locking

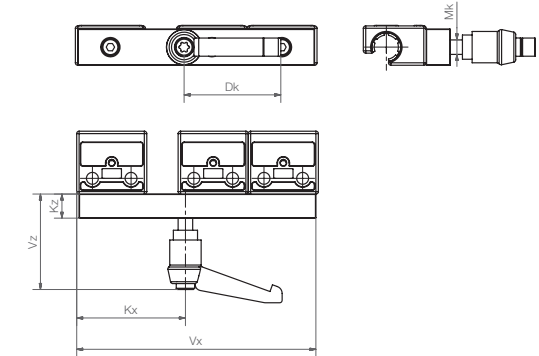

drylin® W Accessories – Load Data and Dimensions [mm]

Part number	Mk	Vx	Kx	Vz	Kz	Dk	Min. holding strength**	Min. tightening torque
WHKD-1010*	M6	100	45	40	10	40	70 N	2.5 Nm
WHKD-1015*	M6	150	95	40	10	40	70 N	2.5 Nm
WHKD-1615*	M8	150	81	40	12	40	90 N	3.5 Nm
WHKD-1620*	M8	200	131	10	12	40	90 N	3.5 Nm
WHKD-2015*	M8	150	63	40	12	40	90 N	3.5 Nm
WHKD-2020*	M8	200	113	40	12	40	90 N	3.5 Nm

* Manual clamp is also available as complete carriage (suffix HKA, order example WW-10-40-10-HKD)
▶ complete carriage WW, page 963

** Condition: dry rail surface

Hint:

The creep behavior of the clamped plastic causes a slackening in clamping force over time (up to 70 %). Therefore safety-related parts should not be clamped.

 **delivery** from stock
time

 **prices** price list online
www.igus.eu/eu/drylinW

 **order key**
complete ▶ page 972