



Order key

Type	Size	Option
------	------	--------

WJ200UMT-01-10-AL

drylin® W	Liner iglidur® J200	Housing bearing, round	Tandem	Standard	Size	Aluminium
-----------	------------------------	---------------------------	--------	----------	------	-----------

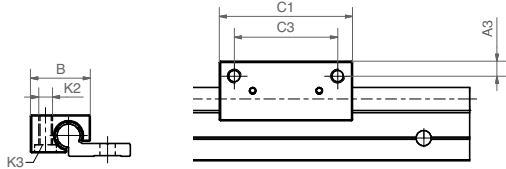

Technical data and dimensions [mm]

Part No.	Weight [g]	B	C1	C3	A3	K2	K3	Static load capacity		
								Coy [N]	Coz+ [N]	Coz- [N]
WJ200UMT-01-10-AL	43	26	58	45	6.5	M6	M5	2,400	2,400	500
WJ200UMT-01-16-AL	32	34.5	72	54	9	M8	M6	2,400	2,400	600

Can be combined with:



Suitable liner materials



Order key

Type	Size
------	------

WJ200UME-01-10

drylin® W	Liner iglidur® J200	Housing bearing, round	Adjustable	Standard	Size
-----------	------------------------	---------------------------	------------	----------	------

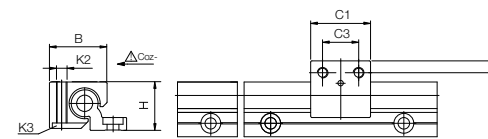

Technical data and dimensions [mm]

Part No.	Weight [g]	B	C1	C3	A3	K2	H	SW	G1	Stat. load capacity		
										Coy [N]	Coz+ [N]	Coz- [N]
WJUME-01-10	43	26	29	16	6.5	M6	18	1.5	27	560	560	250
WJ200UME-01-16	110	34.5	36	18	9	M8	27	2.5	33	980	980	460
WJ200UME-01-20	222	42.5	45	27	9	M8	36	2.5	38	1,500	1,500	500



Allen key supplied

Can be combined with:



Suitable liner materials

