

**Option KMA\* - pivoting**

- Recommended for unsupported and gliding applications
- Option - KMA with Quickflange
- Short and long travels
- Universal mountable with attachment capability on all sides

\*KMA = Polymer Metal Mounting Bracket

Moving end (outer link)  
680...1

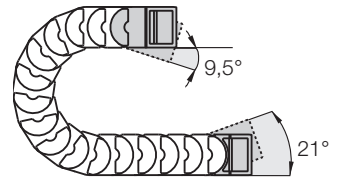

680...2

Fixed end (inner link)

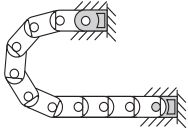

The attachment variants arising automatically by the choice of the KMA mounting bracket

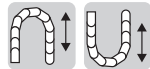

**Option KMA - locking**

- Recommended for vertical hanging / standing applications
- Option - KMA with Quickflange
- At very high speed and acceleration
- Universal mountable with attachment capability on all sides
- Flush mounting at both ends of the E-Tube

Moving end (outer link)  
680...3

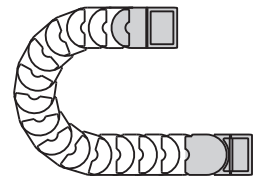

680...4

Fixed end (inner link)

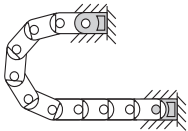

The attachment variants arising automatically by the choice of the KMA mounting bracket

**Dimensions and order configurations**



Quickflange upon request

**Part No. structure (pivoting)**

680.	100.	12	A
------	------	----	---



A... must be indicated on preassembled configurations  
Full set pivoting = 12  
Width  
KMA for selected chain type

**Full set, for both ends:**

680.100.12

**Single-part order:**

680.100.1

Mounting bracket with bore

680.100.2

Mounting bracket with pin

**Part No. structure (locking)**

680.	100.	34	A
------	------	----	---

A... must be indicated on preassembled configurations  
Full set locking = 34  
Width  
KMA for selected chain type

**Full set, for both ends:**

680.100.34

**Single-part order:**

680.100.3

Mounting bracket with bore

680.100.4

Mounting bracket with pin

**Quickflange**

Part No. 16800.QF, unassembled

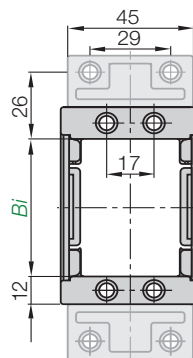

**680...1 Standard! (pivoting)**

**680...3 (locking)**

**Moving end**

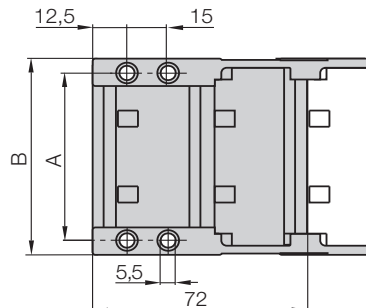

**Standard! (pivoting) 680...2**

**(locking) 680...4**

**Fixed end**

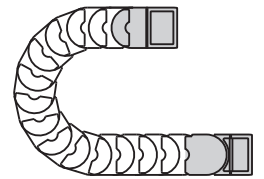

For Series	Part No. Full set	Part No. Full set with Quickflange	Dim. A [mm]	Dim. B [mm]
68.050. ▶	680.050. <input type="checkbox"/>	680.050. <input type="checkbox"/> QF	62	74
68.075. ▶	680.075. <input type="checkbox"/>	680.075. <input type="checkbox"/> QF	87	99
68.100. ▶	680.100. <input type="checkbox"/>	680.100. <input type="checkbox"/> QF	112	124
68.115. ▶	680.115. <input type="checkbox"/>	680.115. <input type="checkbox"/> QF	127	139
68.125. ▶	680.125. <input type="checkbox"/>	680.125. <input type="checkbox"/> QF	137	149
68.150. ▶	680.150. <input type="checkbox"/>	680.150. <input type="checkbox"/> QF	162	174
68.175. ▶	680.175. <input type="checkbox"/>	680.175. <input type="checkbox"/> QF	187	199
68.200. ▶	680.200. <input type="checkbox"/>	680.200. <input type="checkbox"/> QF	212	224
68.225. ▶	680.225. <input type="checkbox"/>	680.225. <input type="checkbox"/> QF	237	249
68.250. ▶	680.250. <input type="checkbox"/>	680.250. <input type="checkbox"/> QF	262	274

Please add the Part No. with the requested index - 12 for the pivoting configuration

e.g. 680.100.12 or 34 for the locking configuration e.g. 680.100.34

For the preassembled mode please add the index A e.g. 680.100.34 A

Quickflange unassembled: Part No. 16800.QF

The following parts are required for attachment of the mounting brackets:

- Socket head cap bolt M5 DIN 912-8.8 Length depends on the thickness of the attachment base
- Washer 5,3 DIN 125-ST ● Hexagon nut M5 DIN 934-8

igus GmbH  
51147 Cologne

Internet: www.igus.eu  
E-mail: info@igus.de

