

**Flange mounting brackets made of steel**

- Metallic flange brackets with popular hole patterns, easily be replaced by their modern successors, without having to alter the hole pattern
- Bolted connection outside of chain cross-section possible
- Universal mountable with attachment capability on all sides
- Steel, galvanized
- One-piece mounting bracket
- High stability

Moving end (outer link)  
906.462.X.1

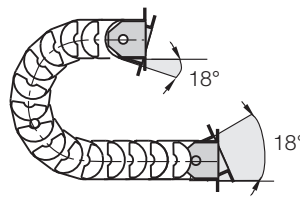

906.462.X.2  
Fixed end (inner link)

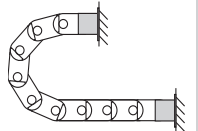

Flush mounting possibilities at both ends of the E-Tube

906.462.X.1  
Moving end

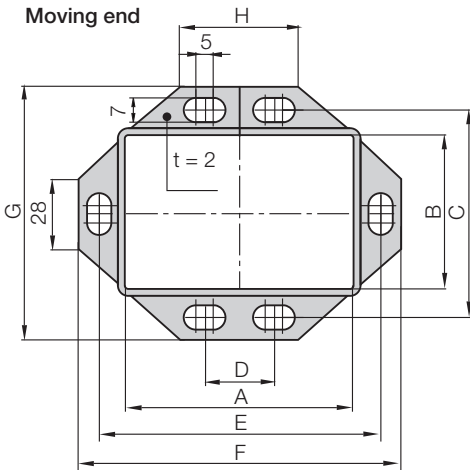

Hole pattern metallic flange  
Moving end 906.462.X.1

906.462.X.2  
Fixed end

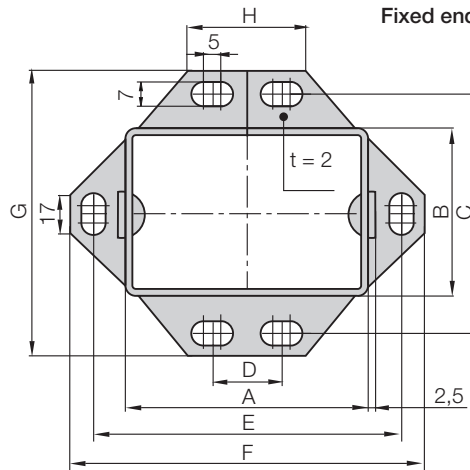

Hole pattern metallic flange  
Fixed end 906.462.X.2

**Dimensions and order configurations**

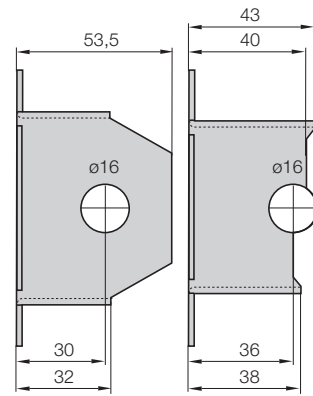

Moving end 906.462.X.1  
Fixed end 906.462.X.2

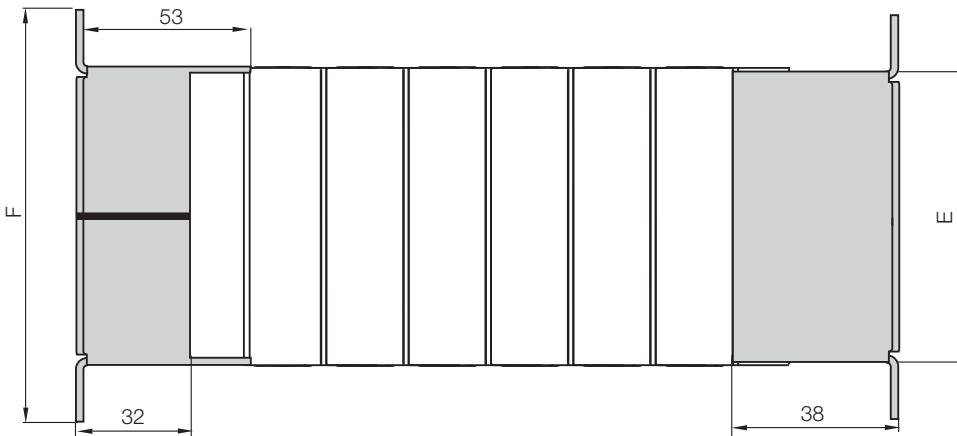

Full set, for both ends:

906. 462. X. 12.

Single-part order:

906. 462. X. 1

Mounting bracket with bore

906. 462. X. 2.

Mounting bracket with pin

For Series	Hole pattern	Part No. Moving end	Part No. Fixed end	Bi [mm]	Ba [mm]	Dim. A [mm]	Dim. B [mm]	Dim. C [mm]	Dim. D [mm]	Dim. E [mm]	Dim. F [mm]	Dim. G [mm]	Dim. H [mm]
68.075	68.1	906.462.1.1	906.462.1.2	75	93	83,4	59	80	30	104	116	95	38
68.115	68.2	906.462.2.1	906.462.2.2	115	133	123,4	59	80	50	144	156	95	78
68.175	68.3	906.462.3.1	906.462.3.2	175	193	183,4	59	80	100	204	216	95	138

Phone +49- (0) 22 03-96 49-800  
Fax +49- (0) 22 03-96 49-222

