

### The Standard - option polymer - pivoting

- Recommended for unsupported and gliding applications
- Well suited for tight installation conditions
- Strain relief with detachable tiwrap plates
- Variable traverse angle for flexible assembly
- The twistability of the E-Chain® and the option to assemble the mounting brackets on the fixed end and/or the moving end, enable various installation options

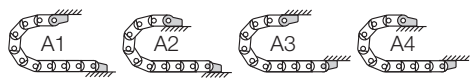

Possible installation conditions for assembled mounting brackets ► Order example "preassembled" below

Moving end with bore  
(outer link) 26...3PZ(B)

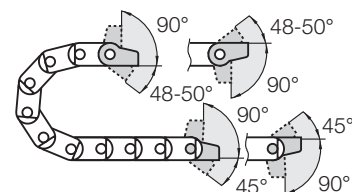

26...4PZ(B) Fixed end  
with pin (inner link)

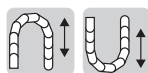

### Option polymer - locking

- Recommended for unsupported and gliding applications
- At very high speed and/or acceleration
- If space is limited for height (the  $H_F$  measurement)
- The twistability of the E-Chain® and the option to assemble the mounting brackets on the fixed end and/or the moving end, enable various installation options

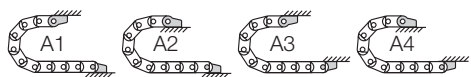

Possible installation conditions for assembled mounting brackets ► Order example "preassembled" below

Moving end with bore  
(outer link) 26...1PZ(B)

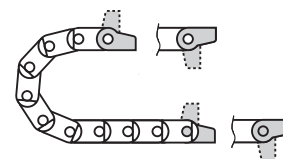

26...2PZ(B) Fixed end  
with pin (inner link)

## Dimensions and order configurations

Strain relief is possible on the moving end and/or the fixed end.

### Part No. structure (pivoting)

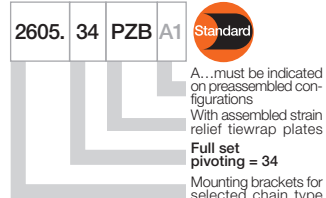

Full set, for both ends:

2605. 34 PZB +tiwrap plate

Single-part order:

2605. 3 PZB +tiwrap plate

Mounting bracket with bore

2605. 4 PZB +tiwrap plate

Mounting bracket with pin

### Part No. structure (locking)

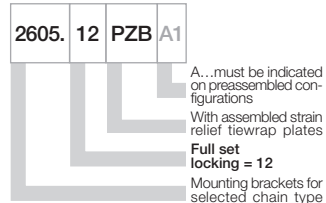

Full set, for both ends:

2605. 12 PZB +tiwrap plate

Single-part order:

2605. 1 PZB +tiwrap plate

Mounting bracket with bore

2605. 2 PZB +tiwrap plate

Mounting bracket with pin

26...3PZ(B) Standard! (pivoting)

26...1PZ(B) (locking)

Moving end

Standard! (pivoting) 26...4PZ(B)

(locking) 26...2PZ(B)

Fixed end

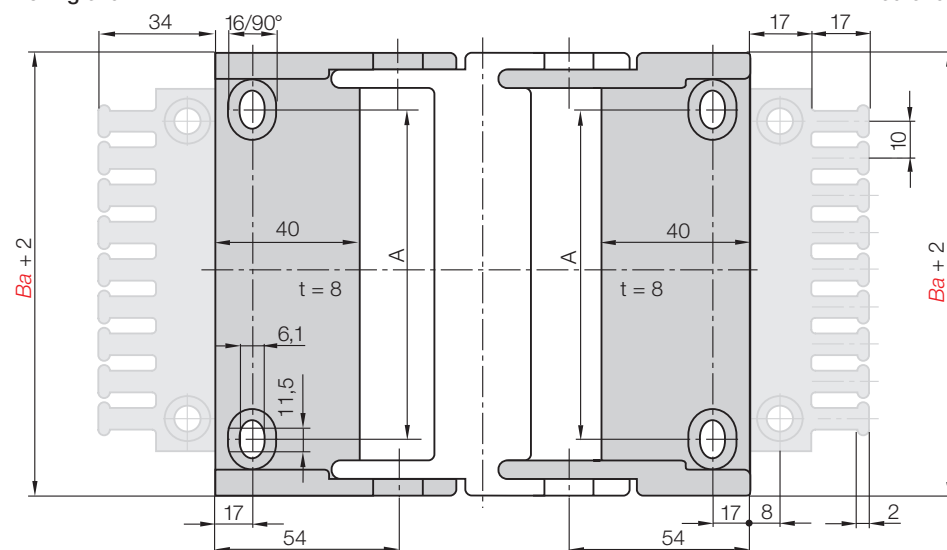

For E-Chain®	Part No. full set with tiwrap plate	Part No. with tiwrap plate + 10 cable tiwraps	Part No. full set without tiwrap plate	Dim. A [mm]
2600 - 2700.05 ►	2605. <input type="checkbox"/> PZB	2605. <input type="checkbox"/> PZBK1	2605. <input type="checkbox"/> PZ	30
2600 - 2700.06 ►	2606. <input type="checkbox"/> PZB	2606. <input type="checkbox"/> PZBK1	2606. <input type="checkbox"/> PZ	45
2600 - 2700.07 ►	2607. <input type="checkbox"/> PZB	2607. <input type="checkbox"/> PZBK1	2607. <input type="checkbox"/> PZ	55
2600 - 2700.09 ►	2609. <input type="checkbox"/> PZB	2609. <input type="checkbox"/> PZBK1	2609. <input type="checkbox"/> PZ	70
2600 - 2700.10 ►	2610. <input type="checkbox"/> PZB	2610. <input type="checkbox"/> PZBK1	2610. <input type="checkbox"/> PZ	80
2600 - 2700.12 ►	2612. <input type="checkbox"/> PZB	2612. <input type="checkbox"/> PZBK1	2612. <input type="checkbox"/> PZ	105
2600 - 2700.15 ►	2615. <input type="checkbox"/> PZB	2615. <input type="checkbox"/> PZBK1	2615. <input type="checkbox"/> PZ	130
2600 - 2700.17 ►	2617. <input type="checkbox"/> PZB	2617. <input type="checkbox"/> PZBK1	2617. <input type="checkbox"/> PZ	155

Please add the Part No. with the requested index - 34 for the pivoting configuration

e.g. 2605. 34 PZB or 12 for the locking configuration e.g. 2605. 12 PZB

For the preassembled mode please add the index A1...A4 e.g. 2605. 34 PZB A1