

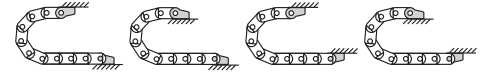

### Steel mounting bracket - locking

- Locked connections
- One part for all chain widths
- Electrically conductive
- Bolted connection outside of chain cross-section possible

Moving end with bore  
(outer link) 260.1

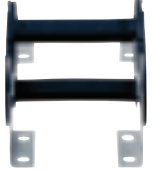
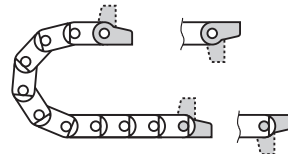

260.2 Fixed end  
with pin (inner link)

Possible installation conditions -  
Further installation angles ► installation sketch

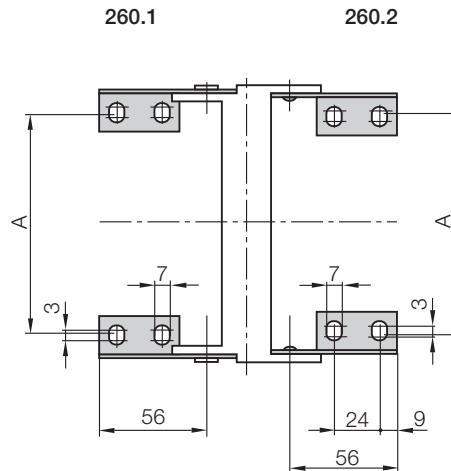
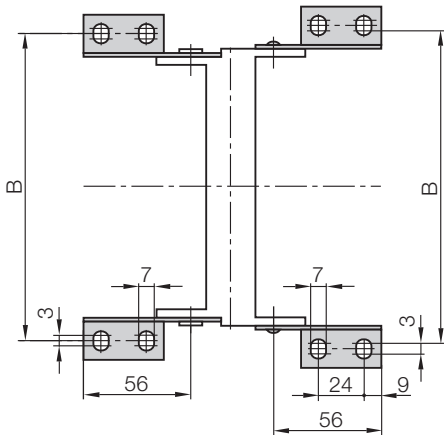

### Dimensions and order configurations

\*pivoting with no stop, (360°)

For E-Chain®	Part No. full set	Dim. A [mm]	Dim. B [mm]
2600 - 2700.05 ►	260. 12	37	83
2600 - 2700.06 ►	260. 12	52	98
2600 - 2700.07 ►	260. 12	62	108
2600 - 2700.09 ►	260. 12	77	123
2600 - 2700.10 ►	260. 12	87	133
2600 - 2700.12 ►	260. 12	112	158
2600 - 2700.15 ►	260. 12	137	183
2600 - 2700.17 ►	260. 12	163	209

260. 12 Full set, 4 parts  
2 with pin / 2 with bore

Single-part order:

260. 1 Mounting bracket  
with bore, 1 part left / right

260. 2 Mounting bracket with  
pin, 1 part left / right

Phone +49- (0) 22 03-96 49-800  
Fax +49- (0) 22 03-96 49-222

