

The Standard - option polymer - pivoting

- Recommended for unsupported and gliding applications
- Well suited for tight installation conditions
- Strain relief with detachable tiwrap plates
- Variable traverse angle for flexible assembly
- The twistability of the E-Chain® and the option to assemble the mounting brackets on the fixed end and/or the moving end, enable various installation options

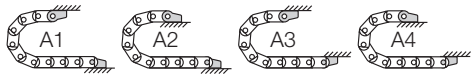

Possible installation conditions for assembled mounting brackets ► Order example "preassembled" below

Moving end with bore
(outer link) 3...3PZ(B)

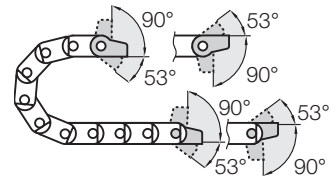

3...4PZ(B) Fixed end
with pin (inner link)

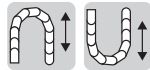

Option polymer - locking

- Recommended for unsupported and gliding applications
- Furthermore:
 - At very high speed and/or acceleration
 - If space is limited for height (the H_f measurement)
 - The twistability of the E-Chain® and the option to assemble the mounting brackets on the fixed end and/or the moving end, enable various installation options

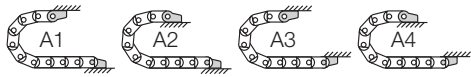

Possible installation conditions for assembled mounting brackets ► Order example "preassembled" below

Moving end with bore
(outer link) 3...1PZ(B)

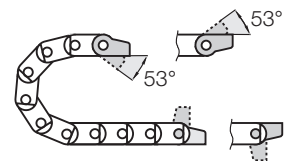

3...2PZ(B) Fixed end
with pin (inner link)

Dimensions and order configurations

Strain relief is possible on the moving end and/or the fixed end.

Part No. structure (pivoting)

3075. 34 PZB A1

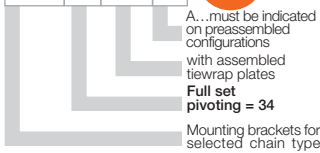

Full set, for both ends:

3075. 34 PZB +tiwrap plate

Single-part order:

3075. 3 PZB +tiwrap plate

Mounting bracket with bore

3075. 4 PZB +tiwrap plate

Mounting bracket with pin

Part No. structure (locking)

3075. 12 PZB A1

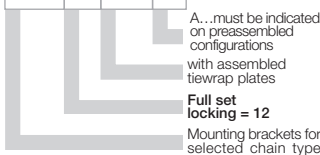

Full set, for both ends:

3075. 12 PZB +tiwrap plate

Single-part order:

3075. 1 PZB +tiwrap plate

Mounting bracket with bore

3075. 2 PZB +tiwrap plate

Mounting bracket with pin

3...3PZ(B) Standard! (pivoting)

3...1PZ(B) (locking)

Moving end

Standard! (pivoting) 3...4PZ(B)

(locking) 3...2PZ(B)

Fixed end

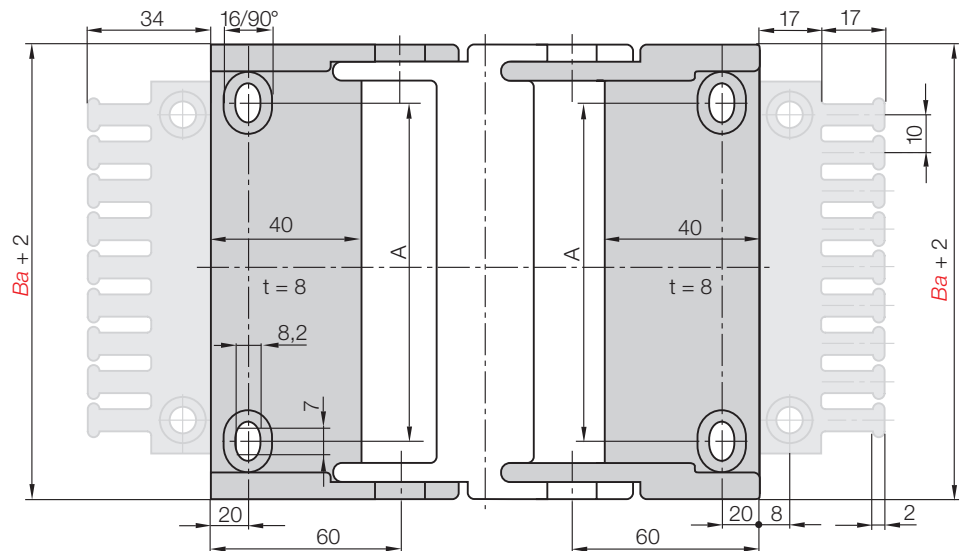

For E-Chain®	Part No. full set with tiwrap plate	Part No. tiwrap plate + 10 cable tiwraps	Part No. full set without tiwrap plate	Number of teeth	Dim. A [mm]
E300/Z300.075	3075. 34 PZB	3075. 34 PZBK1	3075. 34 PZ	7	53
E300/Z300.2/45	3100. 4 PZB	3100. 4 PZBK1	3100. 4 PZ	10	78
E300/Z300.3/45	3150. 4 PZB	3150. 4 PZBK1	3150. 4 PZ	15	128

Please add the Part No. with the requested index - 34 for the pivoting configuration

e.g. 3075. 34 PZB or 12 for the locking configuration e.g. 3075. 12 PZB

For the preassembled mode please add the index A1...A4 e.g. 3075. 34 PZB A1