

● ● ● Price index



UL94-V2 classifications
upon request

- ❶ Version with larger pins and double stop dog for long service life and long unsupported length
- ❷ Mounting bracket with strain relief
- ❸ Dirt-repellent exterior
- ❹ One piece each link
- ❺ Stable design



Easy to assemble and to disassemble



When to use the Series 11.080:

- If space is restricted
- If many cables are arranged vertically adjacent



When not to use it:

- If snap-open links are required
 - ▶ similar width/height from Series Zipper, chapter 4
- If quick insertion of cables with preassembled connectors is required
 - ▶ similar width/height from Series Easy Chain®, chapter 3



Order example complete E-Chain®

Please indicate chain-lengths or number of links Example: 1 m or 33 links

1 m 11.080.038.0



E-Chain®

1 set 11.080.12PZ



Mounting bracket



Unsupported length

FL_G = with straight upper run
 FL_B = with permitted sag
 Further information ► Design, page 1.12

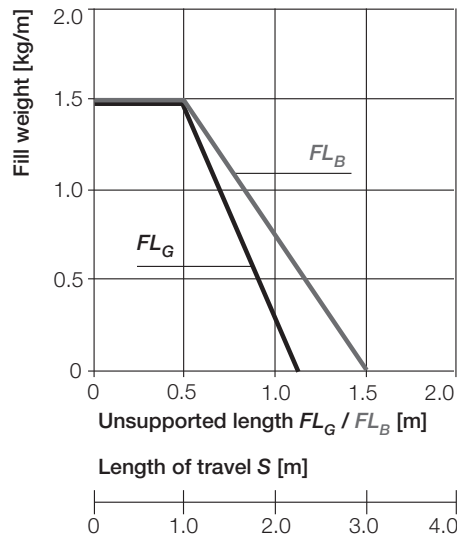
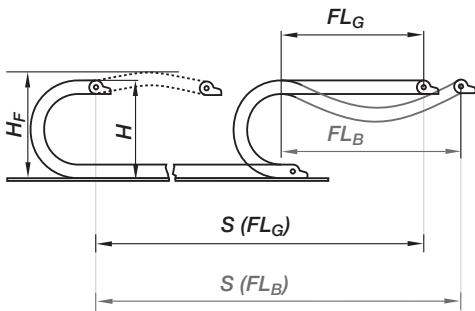

S = Length of travel
 R = Bending radius
 H = Nominal clearance height
 H_F = Required clearance height
 D = Overlength E-Chain® radius in final position
 $K = \pi \cdot R + \text{"safety"}$

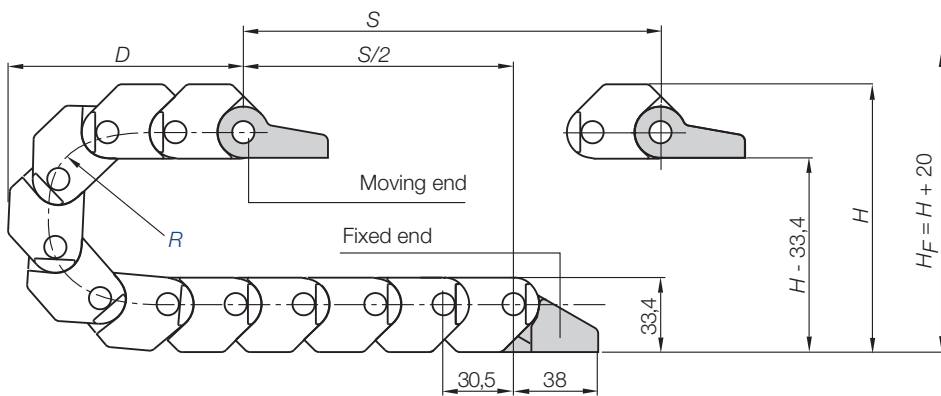

Short travels - unsupported

Unsupported E-Chains® feature positive camber over short travels. This must be accounted for when specifying the clearance height H_F . Please consult igus® if space is particularly restricted.

Pitch = 30,5 mm/link Links/m = 33 (1.006,5 mm) Chain length = $S/2 + K$

R	038
H	110
D	90
K	185

The required clearance height:
 $H_F = H + 20 \text{ mm}$
 (with 0,5 kg/m fill weight)



E2 mini
 Inner height: 28mm

Phone +49- (0) 22 03-96 49-800
 Fax +49- (0) 22 03-96 49-222



Speed / acceleration FL_G	max. 20 [m/s] / max. 200 [m/s ²]
Speed / acceleration FL_B	max. 3 [m/s] / max. 6 [m/s ²]
Gliding speed / acceleration (maximum)	max. 3 [m/s] / max. 10 [m/s ²]
Material - permitted temperature °C	igumid G / -40° up to +120° C
Flammability class, igumid G	VDE 0304 IIC UL94 HB

Technical Data



Details of material properties
 ► page 1.38



► page 5.47

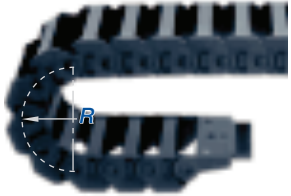
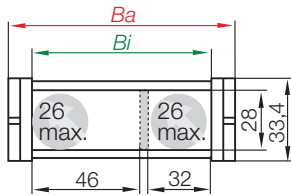

Series 11.080 E-Chain® - non snap-open

Part No.	Bi [mm]	Ba [mm]	R [mm]	Bending radii	Weight [kg/m]
11.080. <input type="text"/> .0	80	93	<input type="text" value="038"/>		≈ 0,73

Supplement Part No. with required radius. Example: 11.080. .0

0 = standard color, other colors ► page 1.39 · Pitch = 30,5 mm/link - Links/m = 33

Part No. structure

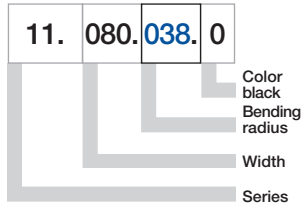



Polymer, one-piece

- One-piece mounting bracket
- Corrosion-resistant
- Available preassembled
- Inner and outer attachment possible
- Available with or without strain relief tiewrap plates

Moving end with bore
(outer link) 11...1P(Z)

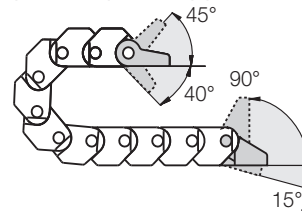

11...2P(Z) Fixed end
with pin (inner link)

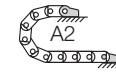

Possible installation conditions for assembled mounting brackets ► Order example "preassembled" below

11...1P(Z)

Moving end

11...2P(Z)

Fixed end

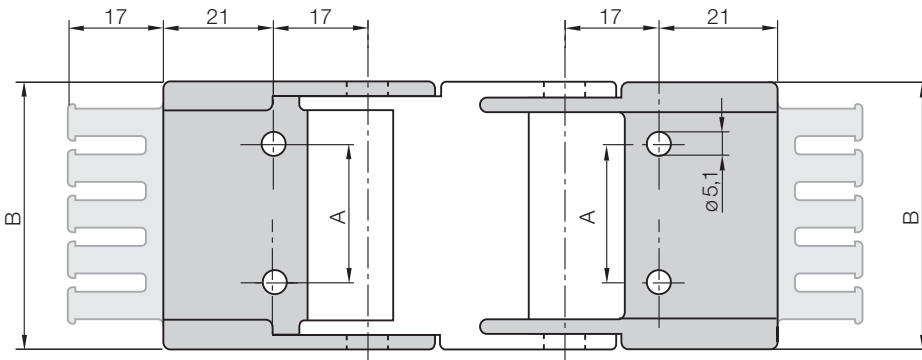

Dimensions and order configurations

Strain relief is possible on the moving end and/or the fixed end.

Part No. structure

11.080. 12 PZ A2

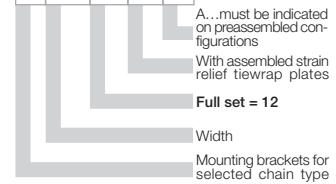

Full set, for both ends:

11.080.12PZ +tiewrap plate

Single-part order:

11.080.1PZ +tiewrap plate

Mounting bracket with bore

11.080.2PZ +tiewrap plate

Mounting bracket with pin

For E-chain®	Part No. full set with tiewrap plate	Part No. full set without tiewrap plate	Dim. A [mm]	Dim. B [mm]
11.080. ►	11.080.12PZ	11.080.12P	65	93

For the preassembled mode please add the index A2 e.g. 11.080.12PZ A2

Phone +49- (0) 22 03-96 49-800
Fax +49- (0) 22 03-96 49-222

