

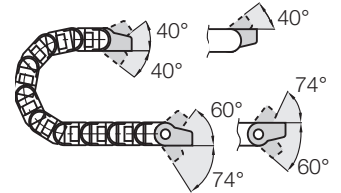

**Option steel - pivoting**

- For pivoting connections
- One part (two-piece) for all chain widths
- Electrically conductive

Moving end  
40400HD.1.E



Fixed end  
40400HD.2.E

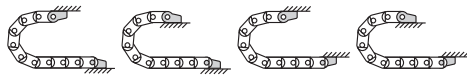

Possible installation conditions -

Further installation angles ► installation sketch

Phone +49- (0) 22 03-96 49-800  
Fax +49- (0) 22 03-96 49-222

igus® GmbH  
51147 Cologne

Moving end  
40400HD.1.E

Fixed end  
40400HD.2.E

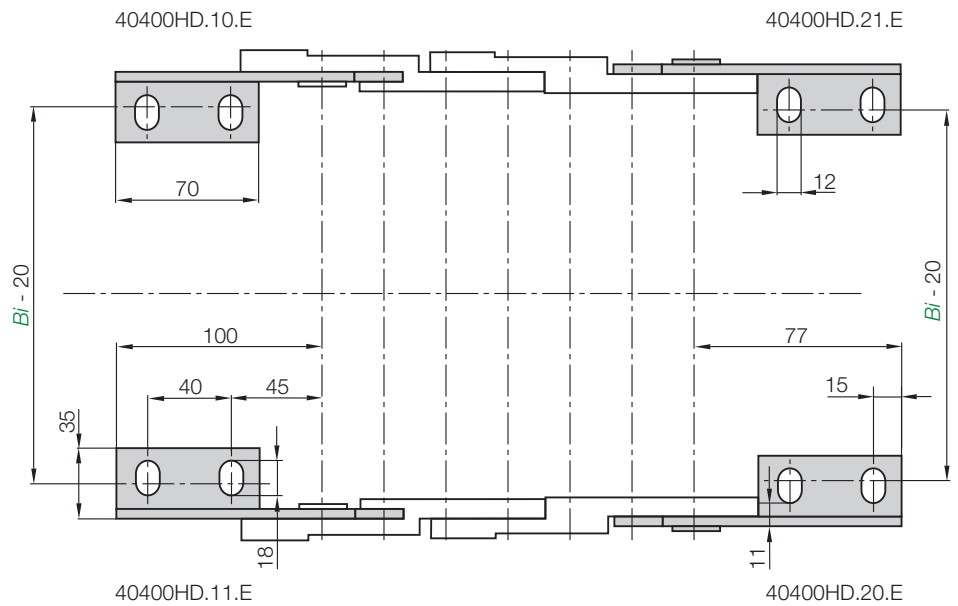

Part No.	Mounting bracket
40400HD.12.E	Full set, 4 parts, 2 with pin / 2 with bore
40400HD.1.E	Mounting bracket moving end, 1 part left / right
40400HD.2.E	Mounting bracket fixed end, 1 part left / right

E4/4 | Series 4040HD·R8840HD | Accessories | Strain Relief

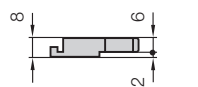

Single tie-wrap plate

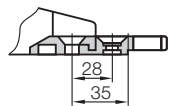

Shown assembled

**Tiewrap plate as individual part**

As individual component screwed on KMA. Can be plugged in the mounting brackets. **Details ► chapter 10**

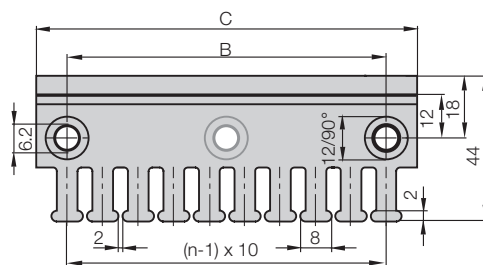

Tiewrap plate	No. of teeth n	Dim. C [mm]	Dim. B [mm]	Center bore
3050.ZB	5	50	30	-
3075.ZB	7	75	55	-
3100.ZB	10	100	80	-
3115.ZB	11	115	95	-
3125.ZB	12	125	105	-
3150.ZB	15	150	130	-
3175.ZB	17	175	155	-
3200.ZB	20	200	180	+
3225.ZB	22	225	205	+
3250.ZB	25	250	230	+

(- = no / + = yes)

Internet: [www.igus.eu](http://www.igus.eu)  
E-mail: [info@igus.de](mailto:info@igus.de)