

The Standard - option polymer - pivoting

- Recommended for unsupported and gliding applications
- Well suited for tight installation conditions
- Available with or without strain relief tiwrap plates
- Variable traverse angle for flexible assembly

Moving end with bore
(outer link) 10...3P(Z)

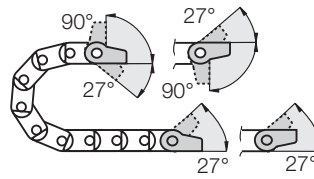

10...4P(Z) Fixed end
with pin (inner link)

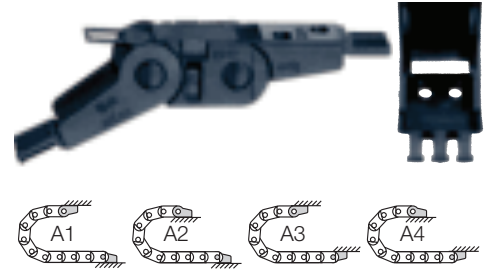

Possible installation conditions for assembled mounting brackets ▶ Order example "preassembled" below

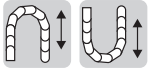

Option polymer - locking

- Recommended for unsupported and gliding applications
- Furthermore:**
- At very high speed and/or acceleration
 - If space is limited for height (the H_F measurement)

Moving end with bore
(outer link) 10...1P(Z)

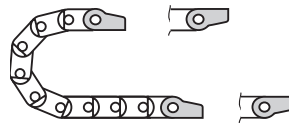

10...2P(Z) Fixed end
with pin (inner link)

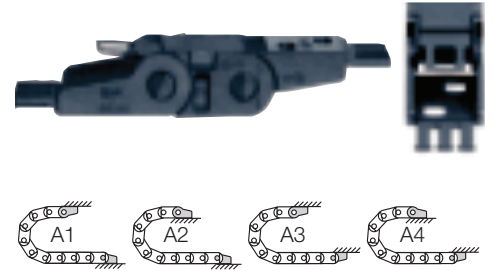

Possible installation conditions for assembled mounting brackets ▶ Order example "preassembled" below

10...3P(Z) Standard! (pivoting)
10...1P(Z) (locking)

Moving end

R15.025

R15.063 - R15.080

Standard! (pivoting) 10...4P(Z)
(locking) 10...2P(Z)

Fixed end

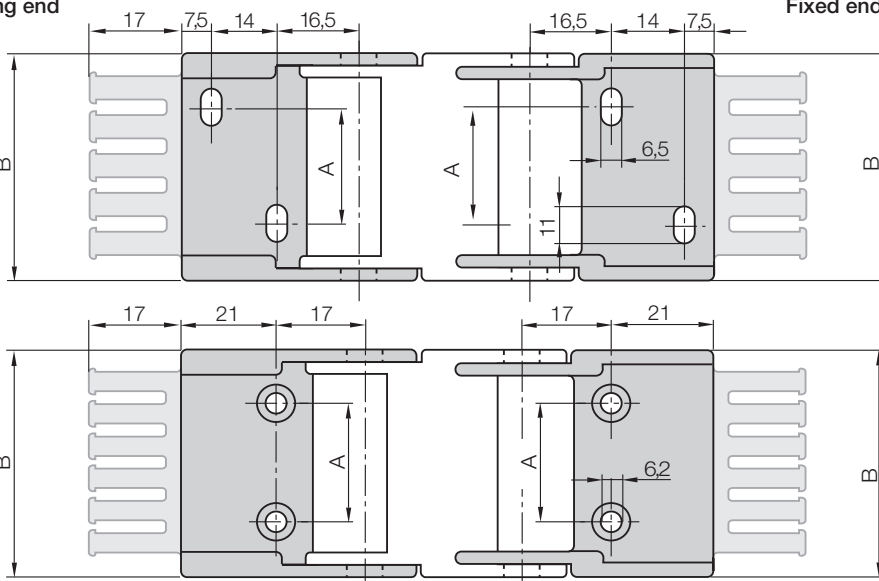

Für E-chain®	Part No. full set with tiwrap plate	Part No. full set without tiwrap plate	Number of teeth	Dim. A [mm]	Dim. B [mm]
R15.025.	▶ 1025. [] PZ	1025. [] P	3	10	35,5
R15.038.	▶ 1038. [] PZ	1038. [] P	4	23	48,5
R15.063.	▶ 105. [] PZ	105. [] P	6	48	75,0
R15.080.	▶ 106. [] PZ	106. [] P	8	65	92,0

Please add the Part No. with the requested index - 34 for the pivoting configuration e.g. 1025. [34] PZ or 12 for the locking configuration e.g. 1025. [12] PZ. For the preassembled mode please add the index [A1] ... [A4] e.g. 1025. [34] PZ [A1]

Dimensions and order configurations

Strain relief is possible on the moving end and/or the fixed end.

Part No. structure (pivoting)

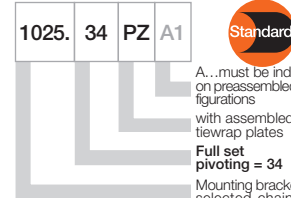

A... must be indicated on preassembled configurations with assembled tiwrap plates
Full set pivoting = 34
Mounting brackets for selected chain type

Full set, for both ends:

1025. [34] PZ +tiwrap plate

Single-part order:

1025. [3] PZ +tiwrap plate

Mounting bracket with bore

1025. [4] PZ +tiwrap plate

Mounting bracket with pin

Part No. structure (locking)

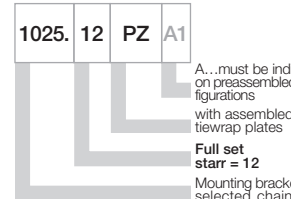

A... must be indicated on preassembled configurations with assembled tiwrap plates
Full set Starr = 12
Mounting brackets for selected chain type

Full set, for both ends:

1025. [12] PZ +tiwrap plate

Single-part order:

1025. [1] PZ +tiwrap plate

Mounting bracket with bore

1025. [2] PZ +tiwrap plate

Mounting bracket with pin

Quicksnap + Quickfix upon request

