

Slim spherical balls made of iglidur® materials for various metallic bearing housings

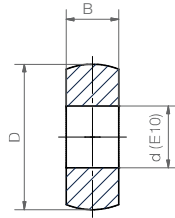

- 3 different spherical ball materials available: iglidur® J, A180 and A350
- Eight dimensions for housing numbers 203 to 210
- Maintenance free dry-running
- High strength
- Corrosion-resistant
- Dirt resistant

Dimensions [mm]

Part No.	Housing No.	d		D	B	Max. static compressive strength	
		E10				radial [kN]	axial [kN]
made of iglidur® J, low friction (material information ► From page 99)							
JEM-17-17	UC203	17		47	17	10.0	7.5
JEM-20-17	UC204	20		47	17	11.5	7.5
JEM-25-17	UC205	25		52	17	14.5	7.5
JEM-30-19	UC206	30		62	19	19.5	9.5
JEM-35-20	UC207	35		72	20	24.0	10.5
JEM-40-21	UC208	40		80	21	29.0	12.0
JEM-45-22	UC209	45		85	22	34.0	13.0
JEM-50-24	UC210	50		90	24	41.5	15.5
made of iglidur® A180, FDA-compliant, allrounder (material information ► From page 325)							
A180EM-17-17	UC203	17		47	17	7.5	6.0
A180EM-20-17	UC204	20		47	17	9.0	6.0
A180EM-25-17	UC205	25		52	17	11.5	6.0
A180EM-30-19	UC206	30		62	19	15.5	7.5
A180EM-35-20	UC207	35		72	20	19.0	8.5
A180EM-40-21	UC208	40		80	21	23.0	9.0
A180EM-45-22	UC209	45		85	22	27.0	10.0
A180EM-50-24	UC210	50		90	24	33.0	12.0
made of iglidur® A350, FDA-compliant, wear resistant (material information ► From page 351)							
A350EM-17-17	UC203	17		47	17	17.0	13.0
A350EM-20-17	UC204	20		47	17	20.0	13.0
A350EM-25-17	UC205	25		52	17	25.0	13.0
A350EM-30-19	UC206	30		62	19	34.0	17.0
A350EM-35-20	UC207	35		72	20	41.5	18.5
A350EM-40-21	UC208	40		80	21	50.0	20.0



Image exemplary

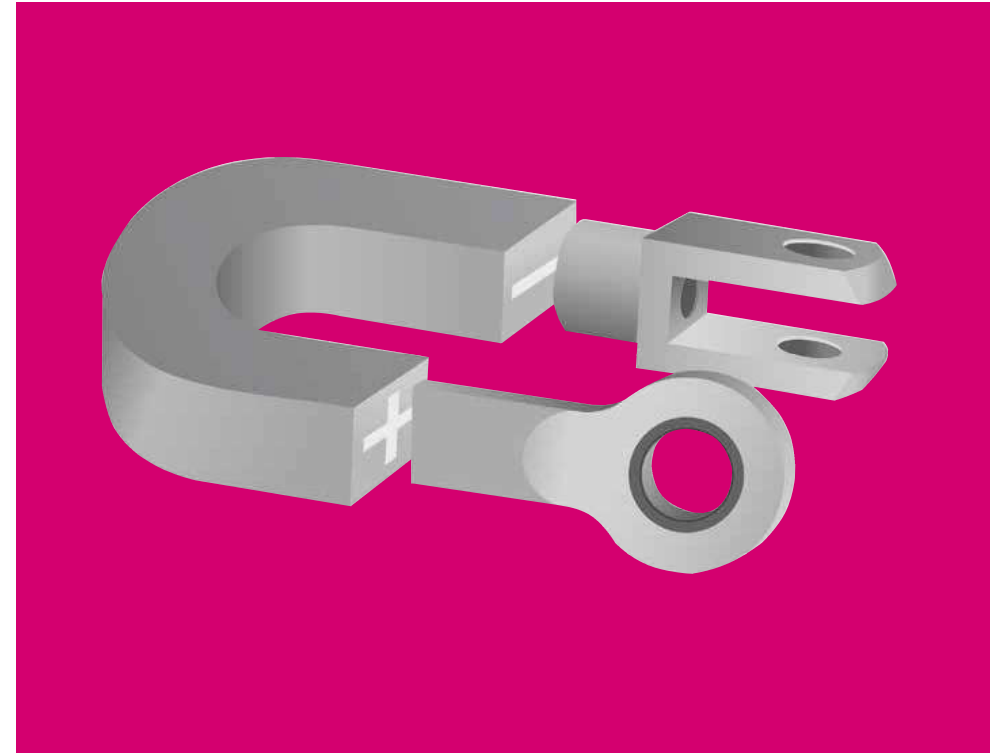

igubal® detectable

- Detectable
- Resistant to dust and dirt
- Lubrication and maintenance free
- Vibration-dampening
- Light weight
- Corrosion-resistant