

SERIES 62NY

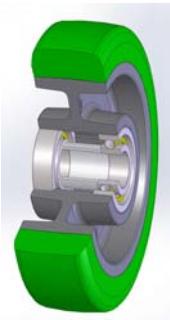

**“TR-ROLL” POLYURETHANE WHEELS, ALSO AVAILABLE WITH
ERGONOMIC ROUND PROFILE
CENTER IN POLYAMIDE 6,
FIXED BRACKET TYPE NL-M**

Wheel description



Tread: “TR-ROLL” polyurethane wheels, hardness 75 Shore A, excellent sliding and elasticity, good resistance to wear and tear.

Center: polyamide 6.

Hub: the housing is obtained by moulding and contains ball bearings series Z.

Bracket description

Standard duty bracket type NL-M (max. load capacity 400 daN)

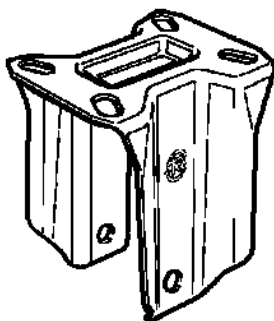

The bracket is made by an electrolytically galvanised steel fork.