

SERIES 62NY

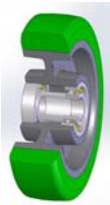

“TR-ROLL” POLYURETHANE WHEELS, ALSO AVAILABLE WITH ERGONOMIC ROUND PROFILE CENTER IN POLYAMIDE 6, SWIVEL TOP PLATE BRACKET TYPE P

Wheel description



Tread: “TR-ROLL” polyurethane wheels, hardness 75 Shore A, excellent sliding and elasticity, good resistance to wear and tear.

Center: polyamide 6.

Hub: the housing is obtained by moulding and contains ball bearings series Z.

Bracket description

Medium-heavy duty bracket type P (max. carrying capacity 400 daN)

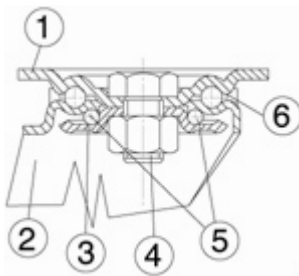

- 1) **Plate:** electrolytically galvanised steel plate
 - 2) **Fork:** electrolytically galvanised steel plate
 - 3) **Ball Racing Ring:** electrolytically galvanised steel plate
 - 4) **King Pin:** steel screw class 8.8 and nut
 - 5) **Swivel actions:** double ring of greased balls
 - 6) **Dust seal:** red polyamide
- Finishing:** yellow galvanisation
Fitting: top plate