

SERIES 75

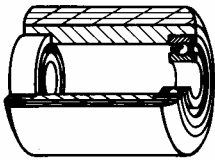

**“TR” POLYURETHANE TRANSPALLET ROLLERS
STEEL CENTRE,
FIXED BRACKET TYPE EE MHD**

Roller description



Tread: “TR” polyurethane tread, hardness 95 +/- 3 Shore A, excellent rolling resistance and elasticity, good resistance to wear and to tearing.

Centre: weldless steel centre.

Hub: The housing is obtained by moulding and turning and contains ball bearings series Z. The hub is available also without bearings.

Bracket description

EE Medium Heavy Duty bracket (max. load capacity 900 daN)

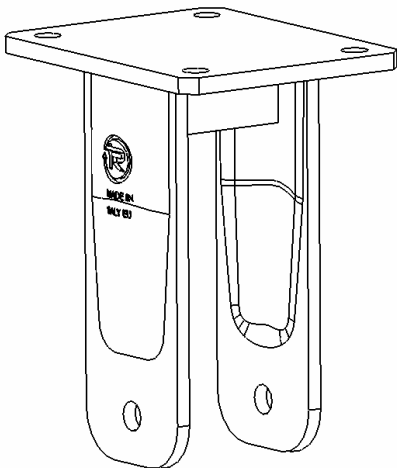

The bracket is made by a steel forged fixing plate with 4 holes, by two steel drawn sides and by a steel central stiffening. These elements are bounded by welding and properly protected against oxydation.