

## Straight stud standpipe adapters

Thread:  
UN/UNF  
ISO 11926-2/3  
SAE J 514

Sealed with O-ring

Tube socket pre-assembled

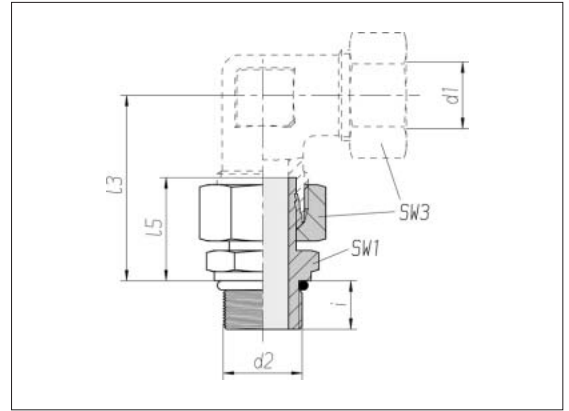

Series	Pressure	d2	SW1	SW3	l3	l5	i	Nm -10 %	kg/100 approx.	Order No.
L 8	PN 315	7/16-20 UNF-2A	17	17	41.5	27.5	9.2	18	3.7	0 1 73 01 20 07*
L 10	PN 315	9/16-18 UNF-2A	19	19	43	28	10.0	30	4.9	0 1 73 02 20 07
L 12	PN 315	3/ 4-16 UNF-2A	24	22	52.5	31.5	11.2	50	10.0	0 1 73 03 20 07
L 15	PN 315	3/ 4-16 UNF-2A	24	27	53.5	32.5	11.2	50	10.0	0 1 73 04 20 07
L 18	PN 315	3/ 4-16 UNF-2A	24	32	55.5	32	11.2	50	12.3	0 1 73 05 20 07
L 18	PN 315	7/ 8-14 UNF-2A	27	32	55.5	32	12.7	60	14.1	0 1 73 06 20 07
L 22	PN 160	7/ 8-14 UNF-2A	27	36	60	32.5	12.7	60	16.8	0 1 73 07 20 07
L 22	PN 160	1 1/16-12 UN -2A	36	36	60	32.5	15.0	95	21.4	0 1 73 08 20 07
L 28	PN 160	1 5/16-12 UN -2A	41	41	65.5	35	15.0	150	19.1	0 1 73 10 20 07
S 8	PN 630	7/16-20 UNF-2A	17	19	54	37	9.2	20	**	0 1 73 30 20 07
S 10	PN 630	9/16-18 UNF-2A	19	22	49.5	32	10.0	35	7.1	0 1 73 15 20 07
S 10	PN 630	3/ 4-16 UNF-2A	24	22	50	32.5	11.2	70	10.0	0 1 73 16 20 07
S 12	PN 630	7/16-20 UNF-2A	17	24	50.5	29	9.2	20	8.1	0 1 73 31 20 07
S 12	PN 630	3/ 4-16 UNF-2A	24	24	54	32.5	11.2	70	10.0	0 1 73 19 20 07
S 14	PN 630	3/ 4-16 UNF-2A	24	27	58.5	36.5	11.2	70	13.6	0 1 73 20 20 07
S 16	PN 400	3/ 4-16 UNF-2A	24	30	56.5	32	11.2	70	17.2	0 1 73 21 20 07
S 16	PN 400	7/ 8-14 UNF-2A	27	30	59.5	35	12.7	100	14.9	0 1 73 22 20 07
S 20	PN 400	7/ 8-14 UNF-2A	30	36	68.5	42	12.7	100	21.0	0 1 73 24 20 07
S 20	PN 400	1 1/16-12 UN -2A	36	36	68.5	42	15.0	170	28.7	0 1 73 25 20 07
S 20	PN 400	1 5/ 8-12 UN -2A	50	36	71.5	45	15.0	285	**	0 1 73 32 20 07
S 25	PN 400	1 1/16-12 UN -2A	32	46	78	48	15.0	170	**	0 1 73 33 20 07
S 25	PN 400	1 5/16-12 UN -2A	41	46	77	47	15.0	270	**	0 1 73 26 20 07
S 30	PN 400	1 5/ 8-12 UN -2A	50	50	86.5	51	15.0	285	**	0 1 73 34 20 07

\* Sample product code, see:  
EVGE08L7/16UNF

\*\* On request