

Raccordi passaparete a saldare

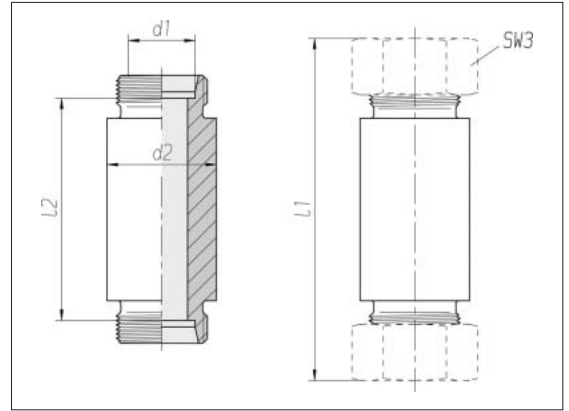

Serie	Pressione	d2	SW3	l1*	l2	kg/100	Codice-Nr.	Codice-Nr.
Tubo Ø est.				ca.		ca.	Parte singola	**
d1								
L 6	PN 315	18	14	85	56	10,3	0 7 41 00 00 00***	0 1 41 00 00 XX
L 8	PN 315	20	17	85	56	12,1	0 7 41 05 00 00	0 1 41 05 00 XX
L 10	PN 315	22	19	87	58	14,3	0 7 41 10 00 00	0 1 41 10 00 XX
L 12	PN 315	25	22	87	58	17,7	0 7 41 15 00 00	0 1 41 15 00 XX
L 15	PN 315	28	27	100	70	25,9	0 7 41 20 00 00	0 1 41 20 00 XX
L 18	PN 315	32	32	101	69	33,4	0 7 41 25 00 00	0 1 41 25 00 XX
L 22	PN 160	36	36	105	73	40,0	0 7 41 30 00 00	0 1 41 30 00 XX
L 28	PN 160	40	41	106	73	44,5	0 7 41 35 00 00	0 1 41 35 00 XX
L 35	PN 160	50	50	114	71	72,3	0 7 41 40 00 00	0 1 41 40 00 XX
L 42	PN 160	60	60	115	70	100,5	0 7 41 45 00 00	0 1 41 45 00 XX
S 6	PN 630	20	17	89	60	13,5	0 7 41 50 00 00	0 1 41 50 00 XX
S 8	PN 630	22	19	89	60	16,2	0 7 41 55 00 00	0 1 41 55 00 XX
S 10	PN 630	25	22	91	59	20,0	0 7 41 60 00 00	0 1 41 60 00 XX
S 12	PN 630	28	24	91	59	25,0	0 7 41 65 00 00	0 1 41 65 00 XX
S 14	PN 630	30	27	107	72	33,7	0 7 41 70 00 00	0 1 41 70 00 XX
S 16	PN 400	35	30	107	71	44,4	0 7 41 75 00 00	0 1 41 75 00 XX
S 20	PN 400	38	36	114	71	51,5	0 7 41 80 00 00	0 1 41 80 00 XX
S 25	PN 400	45	46	120	72	72,3	0 7 41 85 00 00	0 1 41 85 00 XX
S 30	PN 400	50	50	126	73	87,3	0 7 41 90 00 00	0 1 41 90 00 XX
S 38	PN 315	60	60	133	72	125,1	0 7 41 95 00 00	0 1 41 95 00 XX

Integrazione del codice-nr. per raccordi completi	
Raccordo per tubi	Integrazione del codice-nr.
2S	07
ES-4	09
BV-10	Vedi copertina

* vale per raccordi completi con parti di raccordo per tubi 2S o ES-4, BV-10 Vedi copertina.

** con dado e parti di raccordo per tubi 2S, ES-4 o BV-10

*** Esempio confr.:
ESV06LX
ISO 8434-1-WDBHS-L6-St